

WALTER E. WASHINGTON CONVENTION CENTER INFORMATION & FLOOR PLANS





DETAILS

- Room Types
- Facility Overview
- Floor Plans
- What's Required
- What's Included
- Additional Costs

SPACE FOR EVERY NEED



Grand Lobby



Exhibit Floor, Halls D, E



Halls D, E



Exhibit Floor, Halls A, B, C

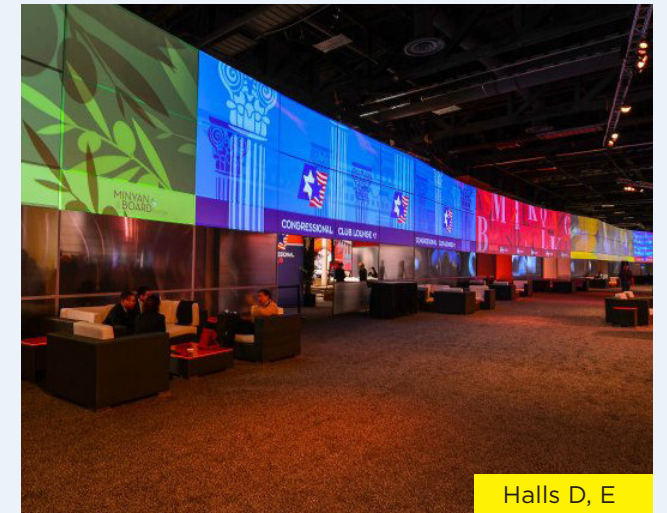

Halls D, E

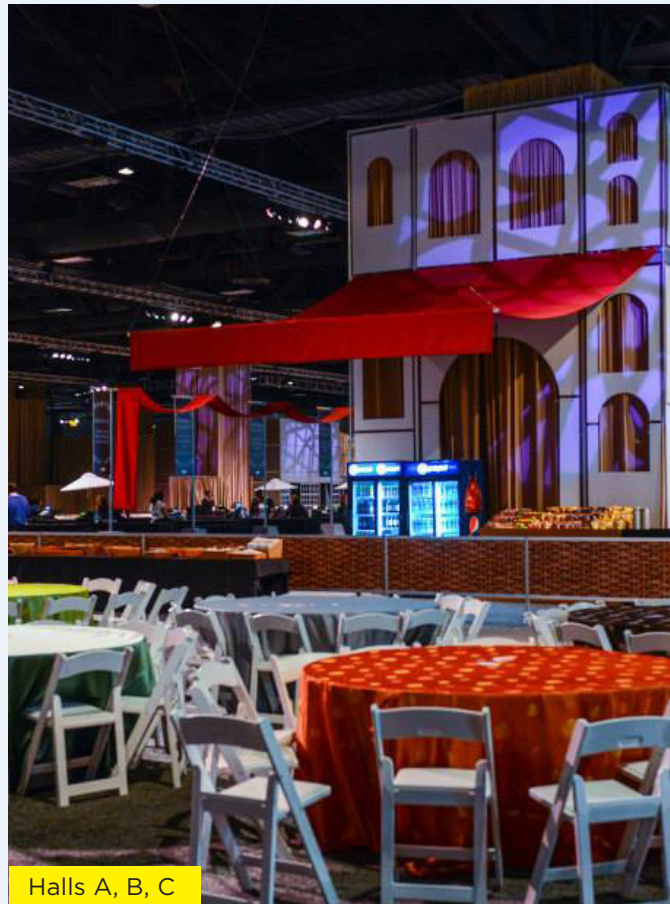

Halls A, B, C



Halls A, B, C



South Pre-Function



Meeting Rooms

FACILITY OVERVIEW

The Walter E. Washington Convention Center, an extraordinary 2.3 million-square-foot conventions and meetings facility, is equipped to handle events of all sizes, from small groups and break-out meetings, to events for 50 to 42,000 attendees.

One of the most energy-efficient buildings for its size, the Convention Center includes a range of mixed-use exhibit spaces, 198,000 square feet of flexible meeting space with a total of 77 meeting rooms and the largest ballroom in the Mid-Atlantic region.

2.3 million total square feet

703,000 square feet of exhibit space

198,000 square feet of flexible meeting space

52,000 square-foot ballroom

77 meeting rooms

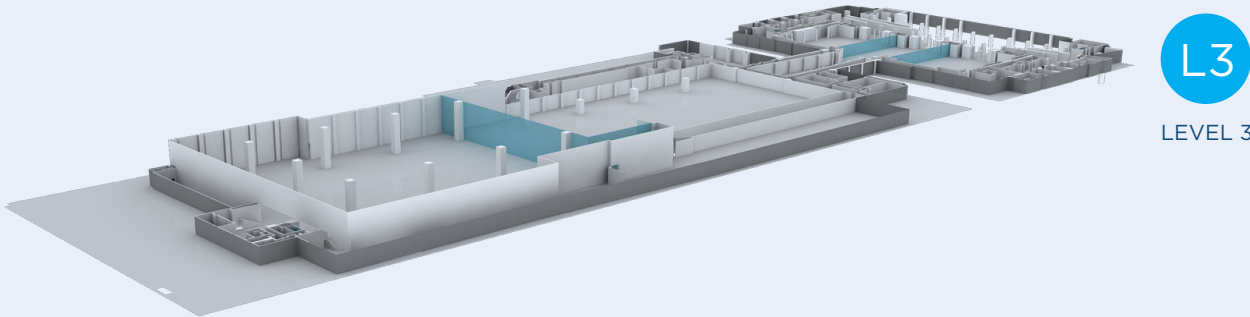

L3
LEVEL 3

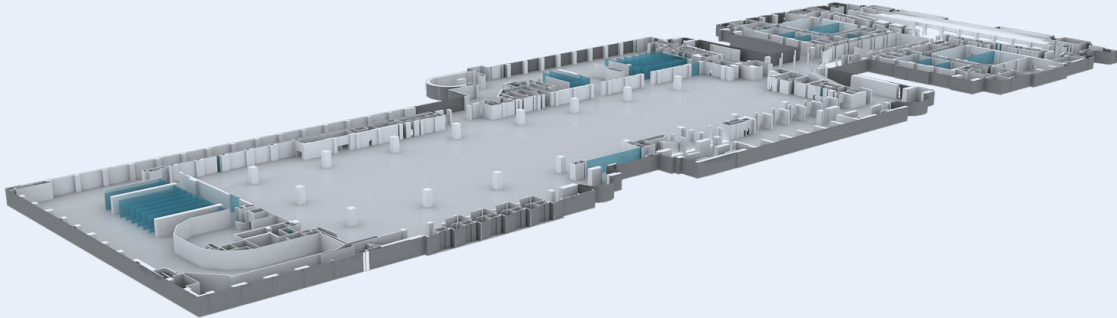

L2
LEVEL 2

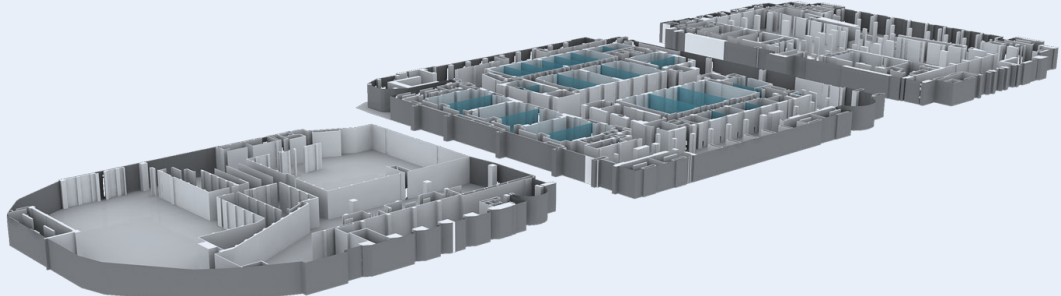

L1
STREET LEVEL



C
CONCOURSE

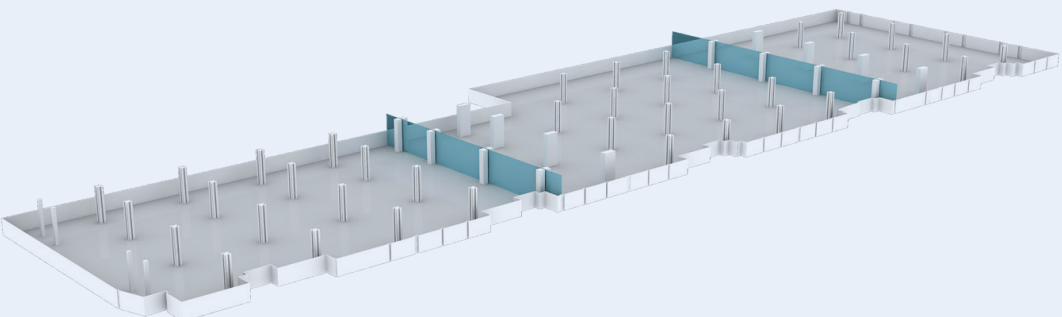

LL
LOWER LEVEL



Lower Level (Level L) Exhibit Halls A, B & C

Halls A, B & C

HALL A
151,000 square feet

HALL B
194,000 square feet

HALL C
128,000 square feet

TOTAL CONTIGUOUS SQUARE FEET
473,000

2347 booths (10 feet x 10 feet)

COLUMNS
Predominantly 90-foot centers; 60-foot centers on the northeast sides of Halls B and C

CEILING HEIGHT
Predominantly 30 feet; 10,000 square foot area at 12 feet on south side of Hall A

FREIGHT DOCKS
39 usable enclosed docks

FREIGHT ACCESS
3 drive-in doors (25 feet wide x 15 feet high)
2 overhead doors (19 feet wide x 15 feet high)

FLOOR LOAD CAPACITY
350 lbs. per square foot

LIGHTING
Hi-Bay fluorescent lights

UTILITIES AND SERVICES
Floor Boxes on 30 foot centers contain:

ELECTRICAL
120/208 volt, single phase and 3 phase

TELEPHONE/DATA
Voice and data outlets; single mode and multimode fiber connections

AUDIO AT MULTIPLE BOXES
XLR mic and line connectors

PLUMBING
3-inch drain at most floor boxes

On Columns:

ELECTRICAL
120/208 volt, single phase and 3 phase

AUDIO AT MULTIPLE COLUMNS
Paging, multipin audio connectors

PLUMBING
1-inch water line; 1-inch compressed air pipe; can be routed to floor boxes via conduit in floor

OVERHEAD
200 amp/208 (total of 30) phase 3 bus duet and 150 amp 480/3 phase (total of 30)

FOOD SERVICE
Three permanent concession stands

RESTROOMS
7 sets of men's and women's rooms, (2 in Halls A and C, 3 in Hall B)

SHOW OFFICES
Overlooking halls, see Concourse Level

FIRST AID
Permanent room; access from inside Hall A and loading dock

KITCHEN
8,000-square-foot service kitchen on south side of Hall A

Information

Capacities and Dimensions

Room #	Usable Dimensions FT, length x width	Usable Dimensions M, length x width	Usable SQ FT	Usable SQ Meters	Ceiling Height	
					FT	M
Hall ABC	353'7" x 1347' w	107.7m x 410.5m	473,000	43,943.1	30'	9.1
Hall AB	353'7" x 929'9" w	107.7m x 283.4m	345,000	32,051.5	30'	9.1
Hall BC	353'7" x 957'7" w	107.7m x 291.8m	322,000	29,914.8	30'	9.1
Hall A	353'7" x 390'4" w	107.7m x 118.9m	151,000	14,028.4	30'	9.1
Hall B	353'7" x 540' w	107.7m x 164.6m	194,000	18,023.2	30'	9.1
Hall C	275'10" x 416'10" w	84.1m x 127.1m	128,000	11,891.6	30'	9.1

Subtotals based on maximum room configuration capacity

Fire Dept. Columns, Water, Compressed Air & Natural Gas

Hall A					Hall B					Hall C				
Column #	FDC	Water	Comp. Air	Nat. Gas	Column #	FDC	Water	Comp. Air	Nat. Gas	Column #	FDC	Water	Comp. Air	Nat. Gas
A-1		X	X		B-1			X		C-1			X	
A-2			X		B-2			X		C-2			X	
A-3		X	X		B-3			X		C-3		X	X	
A-4			X		B-4			X		C-4			X	
A-4+		X	X		B-4+			X		C-4+			X	
A-5			X	X	B-5	X	X	X		C-5			X	
A-6		X	X	X	B-6			X		C-6		X	X	
A-7	X		X		B-7	X	X	X		C-7	X		X	
A-8		X	X		B-8			X		C-8			X	
A-8+			X		B-8+			X		C-8+		X	X	
A-9		X	X	X	B-9			X		C-9	X	X	X	X
A-10	X		X		B-10		X	X		C-10	X		X	
A-11		X	X		B-11			X		C-11		X	X	X
A-12			X		B-12		X	X		C-12			X	
A-12+			X	X	B-12+			X		C-12+			X	X
A-13			X		B-13			X	X	C-13			X	
A-14		X	X		B-14		X	X		C-14		X	X	
A-15	X		X		B-15	X		X		C-15	X		X	
A-16		X	X		B-16		X	X	X	C-16			X	
A-16+			X	X	B-16+			X	X	C-16+		X	X	
					B-17		X	X		C-17	X	X	X	
					B-18			X		C-18			X	
					B-19		X	X		C-19		X	X	
					B-19+			X		C-20			X	
					B-20			X		C-20+			A	
					B-21			X		C-21				
					B-22	X	X	X		C-22				
					B-23			X		C-23				
					B-23+		X	X		C-24				
										C-24+				

Column numbers with "+" indicates eastern wall in line with previous column



Lower Level (Level L)

Exhibit Halls A, B & C

BUILDING LEGEND

<ul style="list-style-type: none"> ■ - COLUMNS W - WOMEN'S RESTROOM M - MEN'S RESTROOM E - ESCALATOR [] - CONCESSIONS [] - MECHANICAL AREAS ⊙ - EXIT 	<ul style="list-style-type: none"> T - TELEPHONES S - STROBES F - FIRE EXTINGUISHER CABINET A - ART WF - WATER FOUNTAIN TH - THERMOSTAT AED - AUTOMATIC EXTERNAL DEFIBRILLATORS 	ELEVATOR LEGEND BUILDING TYPE S - SOUTH M - MIDDLE N - NORTH ELEVATOR TYPE F - FREIGHT ELEVATOR P - PASSENGER ELEVATOR S - SERVICE ELEVATOR EXAMPLE: MP16=MIDDLE PASSENGER ELEVATOR #16	LINETYPE LEGEND --- ROLL-UP DOORS --- AIRWALLS LOW CEILING
---	--	---	--

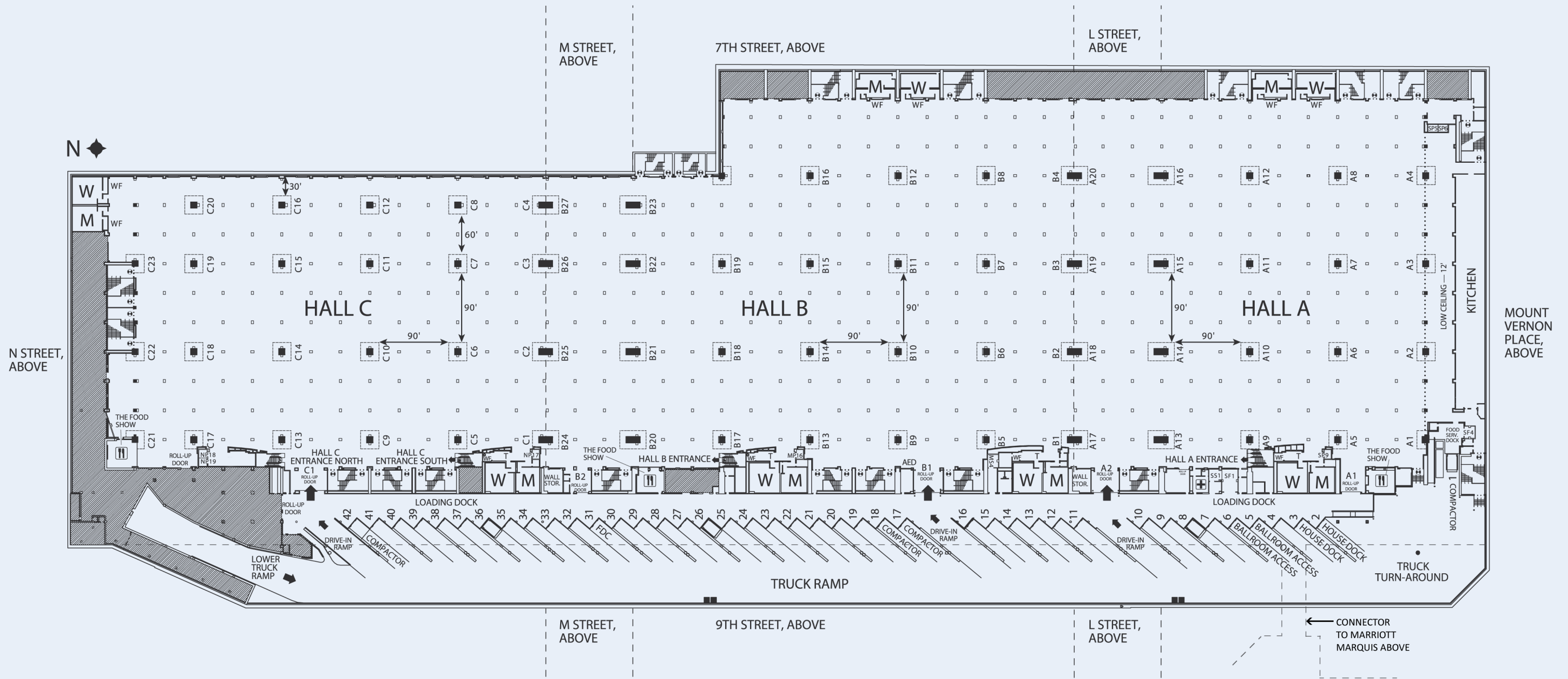
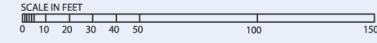



Concourse (Level C) Exhibit Halls A, B & C

Halls A, B & C

SHOW OFFICES
(overlooking halls)

HALL A
1,050 square feet

HALL B
800 square feet

HALL B1
520 square feet

HALL C
800 square feet



BUILDING LEGEND

■ - COLUMNS	T - TELEPHONES	ELEVATOR LEGEND	LINETYPE LEGEND
W - WOMEN'S RESTROOM	S - STROBES	BUILDING TYPE	--- ROLL-UP DOORS
M - MEN'S RESTROOM	F - FIRE EXTINGUISHER CABINET	S - SOUTH	--- MIDDLE
E - ESCALATOR	A - ART	M - MIDDLE	--- NORTH
☐ - CONCESSIONS	WF - WATER FOUNTAIN	N - NORTH	--- AIRWALLS
▨ - MECHANICAL AREAS	TH - THERMOSTAT	ELEVATOR TYPE	--- LOW CEILING
⊙ - EXIT		F - FREIGHT ELEVATOR	
		P - PASSENGER ELEVATOR	
		S - SERVICE ELEVATOR	
		EXAMPLE: MP16=MIDDLE PASSENGER ELEVATOR #16	

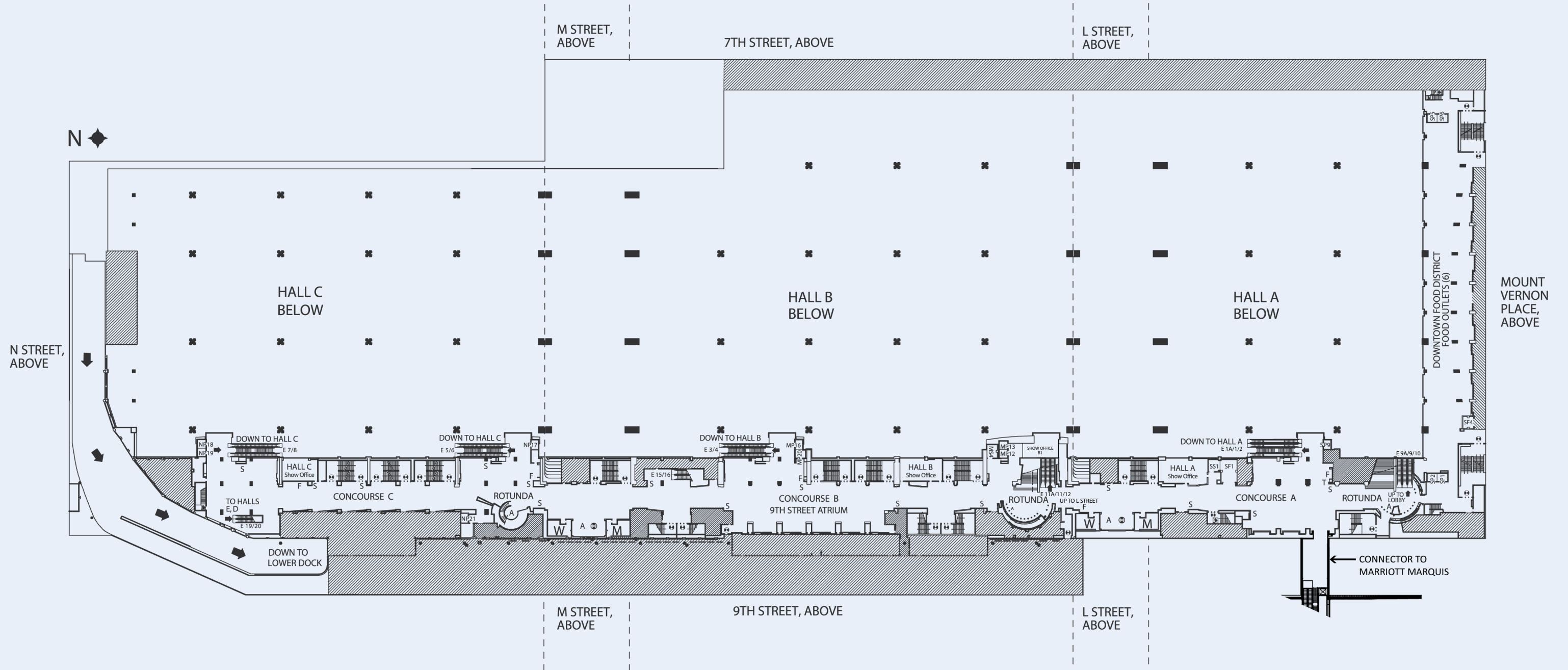



Street Level (Level 1)

Grand Lobby/East & West Salons A-I
Meeting Rooms 101-103 & 140-160
Loading Dock Entrance
Metro Entrance

Grand Lobby

Glass and wood walls with a dramatic staircase

SQUARE FEET
15,000

CEILING HEIGHT
More than 80 feet

LIGHTING
Dimmable incandescent with uplighting on skylights

FLOOR
Granite

COMPLIMENTARY WIFI

FOOD SERVICE
Coffee, café and lounge
Access to restaurant below

RESTROOMS
2 sets of men's and women's rooms

GUEST AMENITIES
Business Center

Meeting Rooms 101-103 & 140-160

UTILITIES AND SERVICES

ELECTRICAL

Wall: 100 amp/208 110 volt
3 phase; 400 amp/208 110 volt 3 phase
Floor: 30A 3 phase

TELEPHONE/DATA

Voice and data connections; single mode and multimode fiber connections

AUDIO

XLR mic and line connectors

LIGHTING

Fluorescent and dimmable incandescent

RESTROOMS

6 sets of men's and women's rooms

Information

Capacities and Dimensions:

Room #	Usable Dimensions FT, length x width	Usable Dimensions M, length x width	Usable SQ FT	Usable SQ Meters	Ceiling Height		Theater*	Banquet**	Classroom***
					FT	M			
101	52'6" x 38'2"	16m x 11.6m	2003	186.1	12'6"	3.8	200	130	99
102AB	72'3" x 45'9"	22m x 13.9m	3324	308.8	12'6"	3.8	330	220	165
102A	45'9" x 29'6"	13.9m x 8.9m	1349	125.3	12'6"	3.8	134	80	66
102B	53'9" x 36'9"	16.4m x 11.2m	1975	183.5	12'6"	3.8	197	130	96
103AB	78'7" x 47'8"	23.9m x 14.6m	3840	356.7	12'5"	3.8	384	250	192
103A	47' x 48'	14.3m x 14.6m	2288	212.5	12'5"	3.8	228	150	114
103B	42'3" x 36'9"	12.8m x 11.2m	1552	144.2	12'5"	3.8	155	100	75
140AB	61' x 51'8"	18.6m x 15.7m	3151	292.7	18'	5.5	315	210	156
140A	51'8" x 30'6"	15.7m x 9.3m	1575	146.3	18'	5.5	157	100	78
140B	51'8" x 30'6"	15.7m x 9.3m	1575	146.3	18'	5.5	157	100	78
141	28'3" x 29'	8.6m x 8.8m	819	76.1	18'	5.5	81	50	39
142	29'7" x 27'8"	9m x 8.4m	819	76.1	18'	5.5	81	50	39
143ABC	85' x 56'6"	25.9m x 17.2m	4802	446.1	17'7"	5.4	480	320	240
143AB	57'6" x 56'6"	17.5m x 17.2m	3248	301.7	17'7"	5.4	324	210	162
143BC	57'6" x 56'6"	17.5m x 17.2m	3248	301.7	17'7"	5.4	324	210	162
143A	56'6" x 27'6"	17.2m x 8.4m	1553	134.1	17'7"	5.4	155	100	75
143B	56'6" x 30'	17.2m x 9.1m	1695	157.5	17'7"	5.4	169	110	84
143C	56'6" x 27'6"	17.2m x 8.4m	1553	144.3	17'7"	5.4	155	100	75
144ABC	87'1" x 56'6"	26.5m x 17.2m	4920	457.1	17'7"	5.4	492	320	246
144AB	59'3" x 56'6"	18.1m x 17.2m	3248	301.7	17'7"	5.4	324	210	162
144BC	57'6" x 56'6"	17.5m x 17.2m	3248	301.7	17'7"	5.4	324	210	162
144A	56'6" x 27'6"	17.2m x 8.4m	1553	144.3	17'7"	5.4	155	100	75
144B	56'6" x 30'	17.2m x 9.1m	1695	157.5	17'7"	5.4	169	110	84
144C	56'6" x 27'6"	17.2m x 8.4m	1553	144.3	17'7"	5.4	155	100	75
145AB	74'2" x 73'	22.6m x 22.3m	5414	503	17'3"	5.3	541	360	270
145A	74'2" x 36'6"	22.6m x 11.1m	2707	251.5	17'3"	5.3	270	180	135
145B	74'2" x 36'6"	22.6m x 11.1m	2707	251.5	17'3"	5.3	270	180	135
146ABC	153'10" x 82'2"	46.9m x 25m	12639	1174.2	17' - 22'	5.2 - 6.7	1263	740	573
146AB	102'11" x 82'2"	31.4m x 25m	8456	785.6	17' - 22'	5.2 - 6.7	845	490	384
146BC	102'11" x 82'2"	31.4m x 25m	8456	785.6	17' - 22'	5.2 - 6.7	845	490	384
146A	82'2" x 50'11"	25m x 15.5m	4183	388.6	17' - 22'	5.2 - 6.7	418	240	189
146B	82'2" x 52'	25m x 15.8m	4272	396.9	17' - 22'	5.2 - 6.7	427	250	192
146C	82'2" x 50'11"	25m x 15.5m	4183	388.6	17' - 22'	5.2 - 6.7	418	240	189
147AB	74'2" x 74'7"	22.6m x 22.7m	5531	513.8	17'3"	5.3	553	360	276
147A	74'2" x 37'7"	22.6m x 11.5m	2787	351.9	17'3"	5.3	278	180	138
147B	74'2" x 37'0"	22.6m x 11.3m	2744	254.9	17'3"	5.3	274	180	135
148	28' x 25'1"	8.5m x 7.6m	7025	652.6	14'	4.3	70	40	33
149AB	64' x 27'	19.5m x 8.2m	1728	160.5	17'6"	5.3	172	110	84
149A	37'7" x 27"	11.5m x 8.2m	744	69.1	17'6"	5.3	74	40	36
149B	27' x 26'5"	8.2m x 8.1m	713	66.2	17'6"	5.3	71	40	33
150AB	70'10" x 73'1"	21.6m x 22.3m	5176	480.9	17'3"	5.3	517	340	258
150A	70'10" x 36'5"	21.6m x 11.1m	2579	239.6	17'3"	5.3	257	170	126
150B	70'10" x 36'6"	21.6m x 11.2m	2585	240.2	17'3"	5.3	258	170	129
151AB	63'4" x 89'2"	19.3m x 27.2m	5647	524.6	17'3"	5.3	564	370	282
151A	63'4" x 44'6"	19.3m x 13.6m	2818	261.8	17'3"	5.3	281	180	131
151B	63'4" x 44'6"	19.3m x 13.6m	2818	261.8	17'3"	5.3	281	180	131
152AB	70'10" x 74'	21.6m x 22.5m	5241	486.9	17'3"	5.3	524	340	261
152A	70'10" x 37'	21.6m x 11.3m	2620	243.4	17'3"	5.3	262	170	129
152B	70'10" x 37'	21.6m x 11.3m	2620	243.4	17'3"	5.3	262	170	129
153	28' x 25'1"	8.5m x 7.6m	702	65.2	14'	4.3	70	40	33
154AB	76'8" x 27'	23.4m x 8.2m	2070	192.3	17'6"	5.3	207	130	102
154A	37'7" x 27"	11.5m x 8.2m	1014	94.2	17'6"	5.3	101	60	48
154B	39'11" x 27"	12.2m x 8.2m	1077	100.1	17'6"	5.3	107	70	51
155	37'2" x 22'4"	11.3m x 6.8m	830	77.1	14'	4.3	80	50	39
156	48'7" x 28'9"	14.8m x 8.8m	1396	129.7	17'6"	5.3	139	90	69
157	28'2" x 18'3"	8.2m x 5.6m	504	75.6	14'	4.3	50	30	24
158AB	59'3" x 24'	18.1m x 8.2m	1422	132.1	14'	4.3	142	90	69
158A	29' x 24'	8.8m x 7.3m	708	65.8	14'	4.3	70	40	33
158B	29' x 24'	8.8m x 7.3m	710	66	14'	4.3	70	40	33
159AB	59'3" x 24'	18.1m x 7.3m	1422	132.1	14'	4.3	142	90	69
159A	22'6" x 24'	6.9m x 7.3m	708	65.8	14'	4.3	70	40	33
159B	22'6" x 24'	6.9m x 7.3m	710	66	14'	4.3	70	40	33
160	24 x 19'7"	7.3m x 5.9m	470	43.7	14'	4.3	47	30	18

* Theater capacities based on chairs set 36" from front edge to front edge.

** Banquet capacities based on 10 chairs per 6' round table set on 11" centers.

*** Classroom capacities based on 3 chairs per 8' x 18" table and 2 chairs per 6' x 18" table.



Street Level

(Level 1)

Grand Lobby/East & West Salons A-I

Meeting Rooms 101-103 & 140-160

Loading Dock Entrance

Metro Entrance

BUILDING LEGEND

■ - COLUMNS	T - TELEPHONES	ELEVATOR LEGEND	LINETYPE LEGEND
W - WOMEN'S RESTROOM	S - STROBES	BUILDING TYPE	--- ROLL-UP DOORS
M - MEN'S RESTROOM	F - FIRE EXTINGUISHER CABINET	S - SOUTH	--- AIRWALLS
E - ESCALATOR	A - ART	M - MIDDLE	--- LOW CEILING
⌈⌋ - CONCESSIONS	WF - WATER FOUNTAIN	N - NORTH	--- SKYFOLD AIRWALLS
▨ - MECHANICAL AREAS	TH - THERMOSTAT	ELEVATOR TYPE	
⊙ - EXIT	ATM - AUTOMATIC TELLER MACHINE	F - FREIGHT ELEVATOR	
	AED - AUTOMATIC EXTERNAL DEFIBRILLATORS	P - PASSENGER ELEVATOR	
		S - SERVICE ELEVATOR	
		EXAMPLE: MP16=MIDDLE PASSENGER ELEVATOR #16	

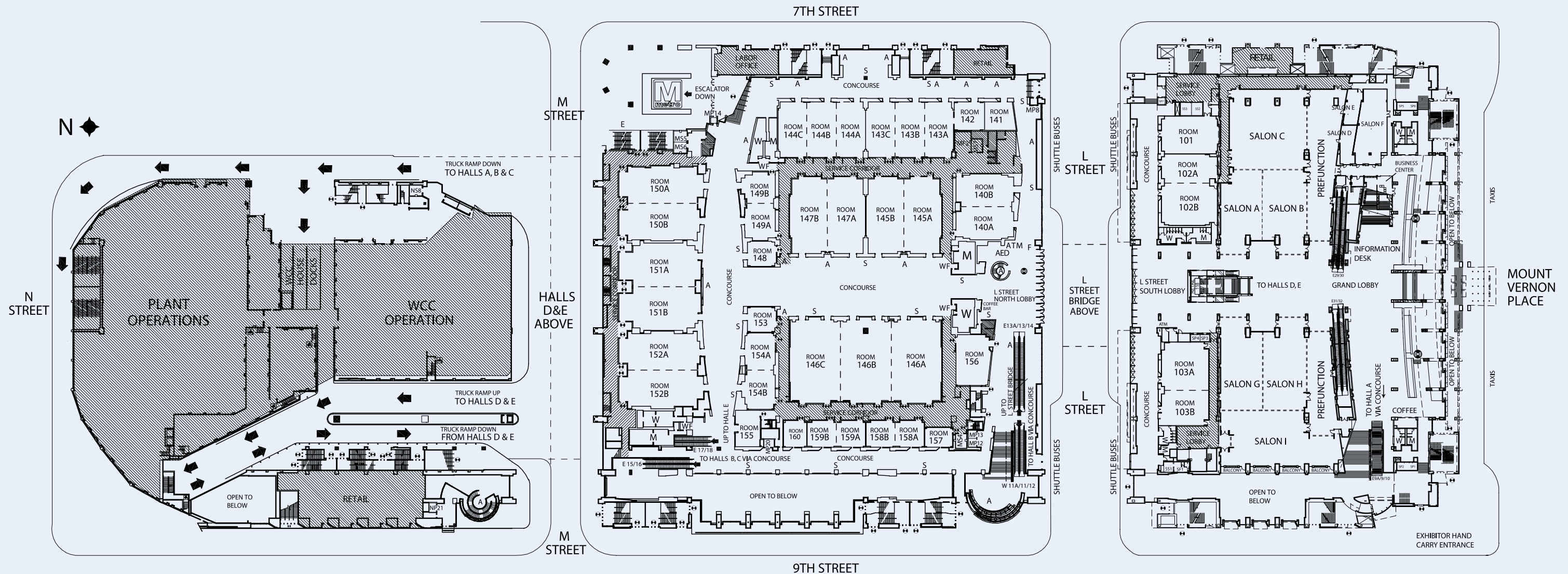

East & West Salons

SQUARE FEET
40,000

CEILING HEIGHT
10 - 18 feet

EAST FREIGHT ACCESS
2 service elevators located on east side for access to Halls D and E loading docks above

WEST FREIGHT ACCESS
1 service elevator located on the west side for access to Halls A, B and C loading docks below

FLOOR LOAD CAPACITY
100 lbs. per square foot

FLOOR
Carpeted

LIGHTING
Dimmable fluorescent with bi-level switching and dimmable incandescent

UTILITIES AND SERVICES

ELECTRICAL
20 amp/120 volt on walls at 15 foot centers
100 amp/208 volt on walls at 30 foot centers

Wall: 100 amp/208 110 volt 3 phase
400 amp/208 110 volt 3 phase
Floor: 30A 3 phase

TELEPHONE/DATA
Voice and data outlets; single mode and multimode fiber connections

AUDIO
XLR mic and line connectors

Capacities and Dimensions: Salons A-I



Room #	Usable Dimensions FT, length x width	Usable Dimensions M, length x width	Usable SQ FT	Usable SQ Meters	Ceiling Height		Theater*	Banquet**	Classroom***
					FT	M			
East Salon									
A	42' x 72'	12.8m x 21.9m	3,024	280.9	18'	5.5	274	170	135
B	44' x 72'	13.5m x 21.9m	3,168	294.3	18'	5.5	288	180	144
C	78' x 80'	23.7m x 24.4m	6,240	579.7	18'	5.5	567	360	282
AB	86' x 72'	26.2m x 21.9m	6,192	575.3	18'	5.5	562	360	279
ABC	152' x 82'	46.3m x 24.9m	12,432	1155	18'	5.5	1130	730	564
AB with Pre-function	72' x 116'	21.9m x 35.3m	10,752	998.9	18'	5.5	977	510	386
ABC with Prefunction	111' X 152'	33.8m x 46.3m	16,992	1578.6	18'	5.5	1416	900	771
Meeting Rooms									
D	13' x 39'	3.9m x 11.9m	507	47.1	10'5"	3.2	46	20	15
E	13' x 36'	3.9m x 10.9m	468	43.5	10'5"	3.2	42	20	12
F	31' x 76'	9.4m x 23.2m	2,356	218.9	10'5"	3.2	214	130	105
West Salon									
G	42' x 82'	12.8m x 24.9m	3,444	320	18'	5.5	313	200	156
H	44' x 82'	13.4m x 24.9m	3,608	335.2	18'	5.5	328	210	162
I	54' x 116'	16.4m x 35.3m	5,964	554.1	18'	5.5	497	350	270
GH	82' x 86'	24.9m x 26.2m	7,052	655.2	18'	5.5	587	400	318
GI	96' x 86'	29.3m x 24.9m	9,408	874	18'	5.5	755	530	426
GHI	86' x 136'	26.2m x 41.5m	13,016	1209.2	18'	5.5	1080	750	591
GH with Pre-function	82' x 111'	24.9m x 33.8m	9,102	845.6	18'	5.5	910	500	411
GHI with Pre-function	111' x 136'	33.8m x 41.5m	16,116	1497.2	18'	5.5	1343	900	732

* Theater capacities based on chairs set 36" front edge to front edge.

** Banquet capacities based on 10 chairs per 6' round table set on 11' centers.

*** Classroom capacities based on 3 chairs per 8' x 18" table and 2 chairs per 6' x 18" table.

BUILDING LEGEND

■ - COLUMNS	T - TELEPHONES	ELEVATOR LEGEND	LINETYPE LEGEND
W - WOMEN'S RESTROOM	S - STROBES	BUILDING TYPE	----- ROLL-UP DOORS
M - MEN'S RESTROOM	F - FIRE EXTINGUISHER CABINET	S - SOUTH	===== AIRWALLS
E - ESCALATOR	A - ART	M - MIDDLE LOW CEILING
 - CONCESSIONS	WF - WATER FOUNTAIN	N - NORTH	----- SKYFOLD AIRWALLS
 - MECHANICAL AREAS	TH - THERMOSTAT	ELEVATOR TYPE	
 - EXIT	ATM - AUTOMATIC TELLER MACHINE	F - FREIGHT ELEVATOR	
	AED - AUTOMATIC EXTERNAL DEFIBRILLATORS	P - PASSENGER ELEVATOR	
		S - SERVICE ELEVATOR	
		EXAMPLE: MP16=MIDDLE PASSENGER ELEVATOR #16	

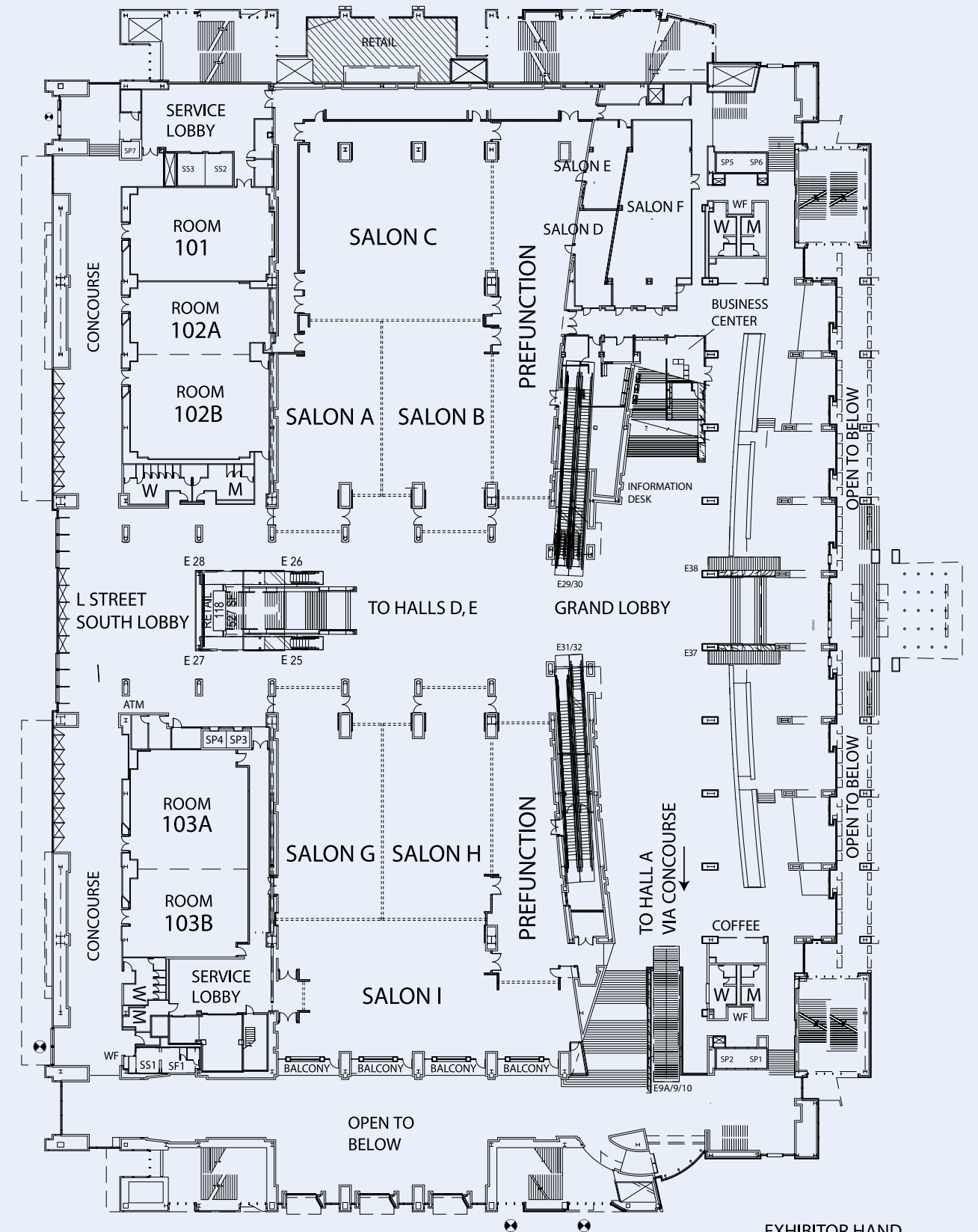

EXHIBITOR HAND
CARRY ENTRANCE



Level Two (Level 2)

Exhibit Halls D & E
Meeting Rooms 201-210
East and West Overlooks

Halls D & E

HALL D
111,000 square feet

HALL E
119,000 square feet

TOTAL CONTIGUOUS SQUARE FEET
230,000 (1,038 booths)
1018 (10' x 10') and 20 (8' x 10') booths

COLUMNS
180-foot clear span between "east to west" columns
90-foot centers between "north to south" columns

CEILING HEIGHT
Ranges from 30 to 50 feet

FREIGHT DOCKS
Hall D: 10 covered docks
Hall E: 10 covered docks

FREIGHT ACCESS
Hall D:
1 drive-in (16 feet wide x 15 feet high),
2 overhead (16 feet wide x 15 feet high)
Hall E:
1 drive-in (20 feet wide x 15 feet high),
1 overhead (20 feet wide x 15 feet high)

FLOOR LOAD CAPACITY
350 lbs. per square foot

LIGHTING
Hi Bay fluorescent and dimmable incandescent

UTILITIES AND SERVICES
Floor boxes on 30 foot centers contain:

ELECTRICAL
120/208 volt, single phase and 3 phase

TELEPHONE/DATA
Single mode and multimode fiber connections

AUDIO AT MULTIPLE BOXES
XLR mic and line connectors
RJ45 audio inputs

PLUMBING
3-inch drain

On Columns:
ELECTRICAL
120/208 volt, single phase and 3 phase

AUDIO AT MULTIPLE COLUMNS
Paging and multipin audio connectors

PLUMBING
1-inch water line; 1-inch compressed air pipe;
can be routed to floor boxes via conduit in floor

OVERHEAD
[13] 200 amp/208 3 phase bus duct
[13] 140 amp/180 volt 3 phase

FOOD SERVICE
Permanent concession stand inside Hall D, food
court outside Hall D, café overlooking Hall E

RESTROOMS
4 sets of men's and women's rooms, (2 sets in
Hall D, 2 sets in Hall E)

SHOW OFFICES
Hall D: 140 square feet (south wall of Hall D)
Hall E: 1,400 square feet (overlooks north side
of Hall E)

FIRST AID
Permanent room; access from inside Hall D and
loading dock

Meeting Rooms 201-210 East and West Overlooks

ELECTRICAL
100 amp/208 volt 3 phase; 400 amp/208 volt 3
phase

TELEPHONE/DATA
Voice and data connections; single mode and
multimode fiber connections

AUDIO
XLR mic and line connectors

LIGHTING
Fluorescent with bi-level switching and
dimmable incandescent

RESTROOMS
4 sets of men's and women's rooms

Information

Capacities and Dimensions: Meeting Rooms 201-210

Room #	Usable Dimensions FT, length x width	Usable Dimensions M, length x width	Usable SQ FT	Usable SQ Meters	Ceiling Height FT	Ceiling Height M	Theater*	Banquet**	Classroom***
201	86'11" x 45'	26.5m x 13.7m	3874	359.9	17'4"	5.3	387	220	174
202AB	78'9" x 100'3"	24m x 30.6m	7913	735.1	16'9"	5.1	790	460	357
202A	78'9" x 52.3"	24m x 15.9m	4126	383.3	16'9"	5.1	412	240	186
202B	78'9" x 48'	24m x 14.6m	3787	351.8	16'9"	5.1	378	220	171
203AB	57'11" x 23'	17.6m x 7m	1313	122	13'6"	4.1	130	70	57
203A	28'9" x 23'	8.8m x 7m	664	61.7	13'6"	4.1	66	40	30
203B	28'9" x 23'	8.8m x 7m	664	61.7	13'6"	4.1	66	40	30
204ABC	97'7" x 41'11"	29.7m x 12.8m	4016	373.1	16'9"	5.1	400	230	180
204AB	59'5" x 41'11"	18.1m x 12.8m	2446	227.2	16'9"	5.1	244	140	111
204BC	68' x 41'11"	20.7m x 12.8m	2795	259.6	16'9"	5.1	279	160	127
204A	42'1" x 29'2"	12.8m x 8.8m	1229	114.2	16'9"	5.1	122	70	54
204B	42'1" x 30'	12.8m x 9.1m	1263	117.3	16'9"	5.1	126	70	57
204C	42'2" x 38'2"	12.8m x 11.6m	1612	149.8	16'9"	5.1	160	90	72
205	26'6" x 20'4"	8.1m x 6.2m	542	50.4	16'	4.9	50	30	20
206	85' x 45'	25.9m x 13.7m	3825	355.4	17'4"	5.3	382	220	171
207AB	78'9" x 99'4"	24m x 30.3m	7842	728.5	16'9"	5.1	784	460	357
207A	78'9" x 52'3"	24m x 15.9m	4126	383.3	16'9"	5.1	412	240	186
207B	78'9" x 48'	24m x 14.6m	3787	351.8	16'9"	5.1	372	220	171
208AB	57'11" x 23'	17.6m x 7m	1313	122	13'6"	4.1	130	70	57
208A	28'9" x 23'	8.8m x 7m	664	61.7	13'6"	4.1	66	40	30
208B	28'9" x 23'	8.8m x 7m	664	61.7	13'6"	4.1	66	40	30
209ABC	88'2" x 42'1"	26.9m x 12.8m	3713	344.9	16'9"	5.1	371	230	180
209AB	59'2" x 42'1"	18m x 12.8m	2492	231.5	16'9"	5.1	249	140	111
209BC	58'11" x 42'1"	17.9m x 12.8m	2446	227.2	16'9"	5.1	244	140	127
209A	42'1" x 29'2"	12.8m x 8.8m	1229	114.2	16'9"	5.1	122	70	54
209B	42'1" x 30'	12.8m x 9.1m	1263	117.3	16'9"	5.1	126	70	57
209C	42'2" x 28'9"	12.8m x 8.8m	1219	113.2	16'9"	5.1	121	70	72
210	24'x21'10"	7.3m x 6.7m	506	47	16'	4.9	50	30	20
East Overlook	39' x 32'	11.8m x 9.7m	1248	115.9	18'	5.5	113	70	54
West Overlook	38'3" x 31'	11.66m x 9.45m	1063	98.8	18'	5.5	70	60	45

* Theater capacities based on chairs set 36" front edge to front edge.
** Banquet capacities based on 10 chairs per 6' round table set on 11' centers.
*** Classroom capacities based on 3 chairs per 8' x 18" table and 2 chairs per 6' x 18" table.

Capacities and Dimensions: Halls D and E

Room #	Usable Dimensions FT, length x width	Usable Dimensions M, length x width	Usable SQ FT	Usable SQ Meters	Ceiling Height FT	Ceiling Height M
Hall DE	225'11" x 781'8"	68.8m x 238.2m	230,000	21,367.7	40'-52'9"	12.2-16.1
Hall D	225'11" x 449'3"	68.8m x 136.9m	111,000	10,312.2	40'-52'9"	12.2-16.1
Hall E	225'11" x 332'11"	68.8m x 101.4m	119,000	11,055.4	40'-52'9"	12.2-16.1

Subtotals based on maximum room configuration capacity

L2  **Level Two**
(Level 2)

Exhibit Halls D & E
Meeting Rooms 201-210
East and West Overlooks

BUILDING LEGEND

<ul style="list-style-type: none"> ■ - COLUMNS W - WOMEN'S RESTROOM M - MEN'S RESTROOM E - ESCALATOR ☐ - CONCESSIONS ▨ - MECHANICAL AREAS ⊙ - EXIT 	<ul style="list-style-type: none"> T - TELEPHONES S - STROBES F - FIRE EXTINGUISHER CABINET A - ART WF - WATER FOUNTAIN TH - THERMOSTAT AED - AUTOMATIC EXTERNAL DEFIBRILLATORS 	<p>ELEVATOR LEGEND</p> <p>BUILDING TYPE</p> <ul style="list-style-type: none"> S - SOUTH M - MIDDLE N - NORTH <p>ELEVATOR TYPE</p> <ul style="list-style-type: none"> F - FREIGHT ELEVATOR P - PASSENGER ELEVATOR S - SERVICE ELEVATOR <p>EXAMPLE: MP16=MIDDLE PASSENGER ELEVATOR #16</p>	<p>LINETYPE LEGEND</p> <ul style="list-style-type: none"> ----- ROLL-UP DOORS ----- AIRWALLS LOW CEILING
---	--	--	--

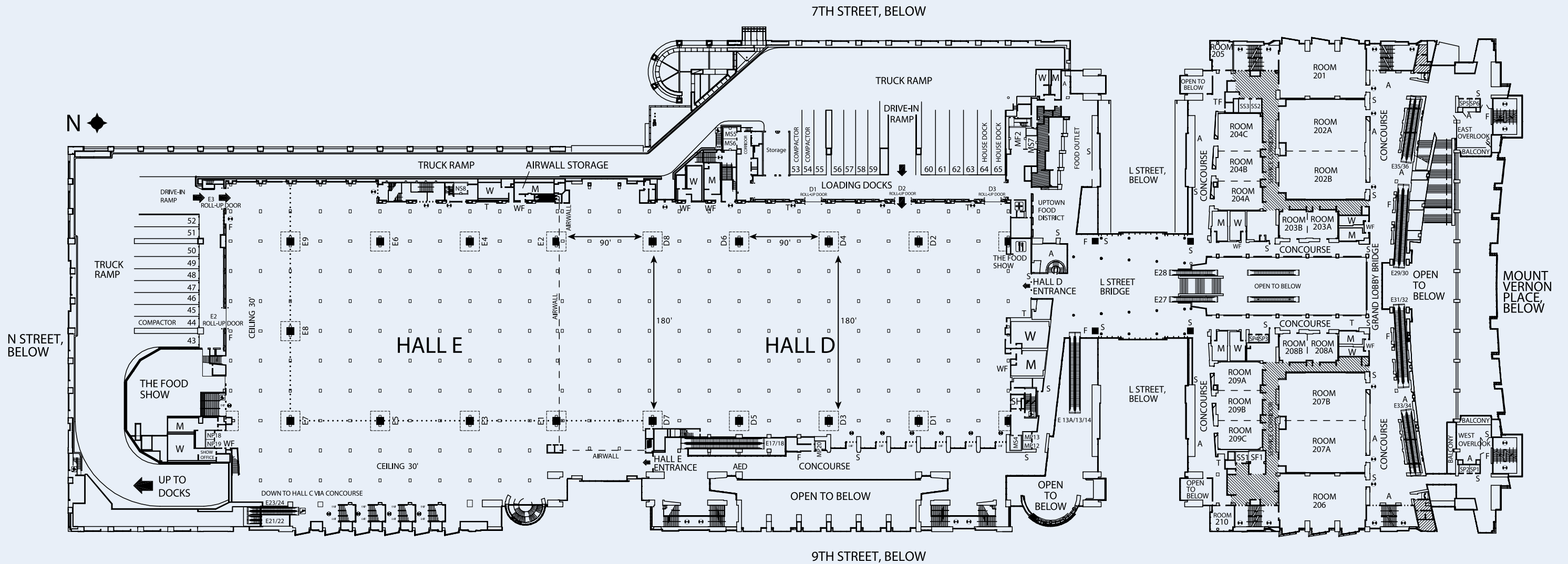
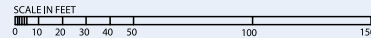



Level Three

(Level 3)

Ballroom

Meeting Rooms 301-306

Kitchen

Ballrooms

BALLROOM A

19,000 square feet (16,400 square feet plus 2,600-square-foot balcony)

BALLROOM B

14,000 square feet

BALLROOM C

19,000 square feet (16,400 square feet plus 2,600-square-foot balcony)

TOTAL USABLE SQUARE FEET

52,000

CEILING HEIGHT

40 to 48 feet high; 10 feet under balconies

SOUTH PRE-FUNCTION

30,000 square feet with natural light

FLOOR LOAD CAPACITY

100 lbs. per square foot

FREIGHT ACCESS

2 service elevators

LIGHTING

Hi Bay fluorescent and dimmable incandescent; multiple preset options

UTILITIES AND SERVICES

ELECTRICAL

100 amp/208 volt 3 phase; 200 amp/208 volt 3 phase; 400 amp/208 volt 3 phase; 60 amp/208 volt 3 phase overhead

TELEPHONE/DATA

Voice and data connections; single mode and multimode fiber connections

AUDIO

XLR mic and line connectors; paging, multipin audio connectors on walls and in floor; A/V Mezzanine across southside of ballroom

RESTROOMS

2 sets of men's and women's rooms

KITCHEN

20,000-square-foot kitchen adjacent to the ballroom

Meeting Rooms 301-306

LIGHTING

Fluorescent with bi-level switching and dimmable incandescent

UTILITIES AND SERVICES

ELECTRICAL

100 amp/208 volt 3 phase

TELEPHONE/DATA

Voice and data connections

AUDIO

XLR mic and line connectors

Information

Capacities and Dimensions: Meeting Rooms 301-306

Room #	Usable Dimensions		Usable SQ FT	Usable SQ Meters		Ceiling Height		Theater*	Banquet**	Classroom***
	FT, length x width	M, length x width		FT	M					
301	25' x 28'10"	7.6m x 8.8m	702	65.2	10'	3	58	40	30	
302	25' x 28'10"	7.6m x 8.8m	702	65.2	10'	3	58	40	30	
303	25' x 28'10"	7.6m x 8.8m	702	65.2	10'	3	58	40	30	
304	25' x 28'10"	7.6m x 8.8m	702	65.2	10'	3	58	40	30	
305	25' x 28'10"	7.6m x 8.8m	702	65.2	10'	3	58	40	30	
306	25' x 28'10"	7.6m x 8.8m	702	65.2	10'	3	58	40	30	

* Theater capacities based on chairs set 36" front edge to front edge.

** Banquet capacities based on 10 chairs per 6' round table set on 11' centers.

*** Classroom capacities based on 3 chairs per 8' x 18" table and 2 chairs per 6' x 18" table.

Capacities and Dimensions: Ballroom ABC

Room #	Usable Dimensions		Usable SQ FT	Usable SQ Meters		Ceiling Height		Theater*	Banquet**	Classroom***
	FT, length x width	M, length x width		FT	M					
Ballroom ABC	267'11" x 140'2"	81.7m x 42.1m	52000	4830.9	40-48'	12.2-14.6	4480	2600	2200	
Ballroom AB	186'8" x 140'2"	56.9m x 42.1m	33000	3065.8	40-48'	12.2-14.6	2820	1550	1325	
Ballroom BC	186'8" x 140'2"	56.9m x 42.1m	33000	3065.8	40-48'	12.2-14.6	2820	1550	1325	
Ballroom A	140'2" x 97'2"	42.1m x 29.6m	16400	1523.6	40-48'	12.2-14.6	1660	1050	875	
Ballroom B	140'2" x 89'6"	42.1m x 27.2m	14000	1300.6	40-48'	12.2-14.6	1160	500	450	
Ballroom C	140'2" x 97'2"	42.1m x 29.6m	16400	1523.6	40-48'	12.2-14.6	1160	1050	875	

* Theater capacities based on chairs set 36" from front edge to front edge.

** Banquet capacities based on 10 chairs per 6' round table.

*** Classroom capacities based on 4 chairs per 8' x 18" table and 3 chairs per 6' x 18" table.

Fire Dept. Columns, Water, Compressed Air & Natural Gas

Hall D					Hall E				
Column #	FDC	Water	Comp. Air	Nat. Gas	Column #	FDC	Water	Comp. Air	Nat. Gas
West entrance wall		X	X		E-1		X	X	
East entrance wall		X	X		E-2	X	X	X	
D-1	X	X	X		E-3		X	X	
D-2		X	X		E-4	X	X	X	
D-3	X	X	X	X	E-5		X	X	X
D-4	X	X	X	X	E-6		X	X	X
D-5		X	X		E-7		X	X	
D-6	X	X	X		E-8		X	X	
D-7	X	X	X		E-9	X	X	X	
D-8	X	X	X						



Level Three

(Level 3)

Ballroom

Meeting Rooms 301-306

Kitchen

BUILDING LEGEND

<ul style="list-style-type: none"> ■ - COLUMNS W - WOMEN'S RESTROOM M - MEN'S RESTROOM E - ESCALATOR ☐ - CONCESSIONS ▨ - MECHANICAL AREAS ⊙ - EXIT 	<ul style="list-style-type: none"> T - TELEPHONES S - STROBES F - FIRE EXTINGUISHER CABINET A - ART WF - WATER FOUNTAIN TH - THERMOSTAT AED - AUTOMATIC EXTERNAL DEFIBRILLATORS 	<p>ELEVATOR LEGEND</p> <p>BUILDING TYPE</p> <ul style="list-style-type: none"> S - SOUTH M - MIDDLE N - NORTH <p>ELEVATOR TYPE</p> <ul style="list-style-type: none"> F - FREIGHT ELEVATOR P - PASSENGER ELEVATOR S - SERVICE ELEVATOR <p>EXAMPLE: MP16=MIDDLE PASSENGER ELEVATOR #16</p>	<p>LINETYPE LEGEND</p> <ul style="list-style-type: none"> ----- ROLL-UP DOORS ----- AIRWALLS LOW CEILING
---	--	---	---

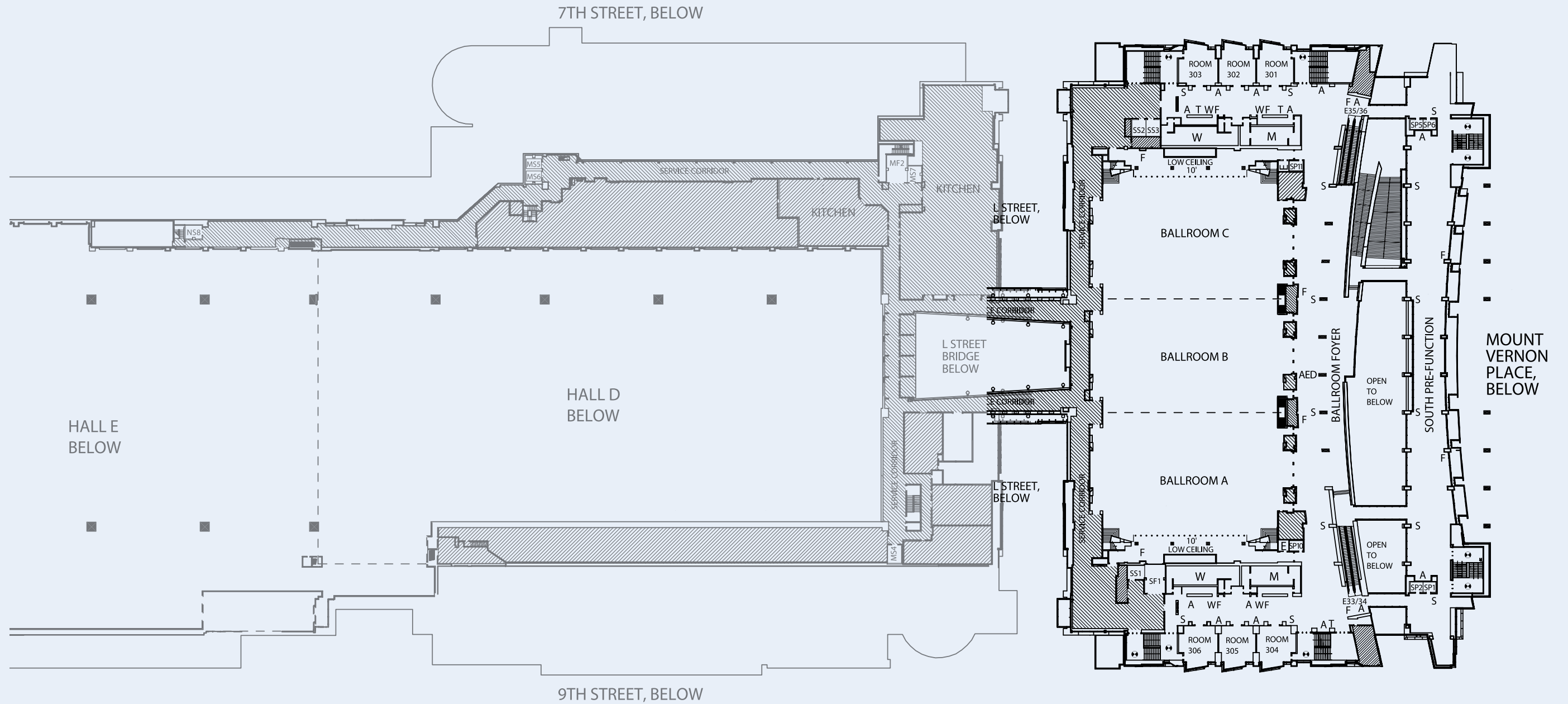
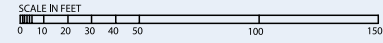

WHAT'S REQUIRED

REQUIRED FOR ALL EVENTS



INSURANCE

Required for all events, except the US Government. A certificate of insurance confirming the existence of a liability insurance policy in the amount of \$2 million (\$2,000,000 USD) is required. The policy must name the Washington Convention and Sports Authority, its Board of Directors, officers, employees, and the District of Columbia government as additional insured's.

REQUIRED FOR ALL EVENTS WITH MORE THAN 500 PEOPLE

(Note: All requests are based on event requirements and subject to final approval by Walter E. Washington Convention Center security staff.)



MEDICAL

A medical service provider must be on duty during move in/move out. On show days, the provider must be on duty 30 minutes prior to the event start time until 30 minutes after the event concludes. A list of "Approved Health Care Providers" whom we have qualified to provide services in the Walter E. Washington Convention Center can be provided by the Convention Management Department.*

* Customers are responsible for the medical needs of their attendees and must contract with an independent medical provider.



SECURITY

This requirement includes possible use of Metropolitan Police Department (MPD) officers. The security requirement also applies when any product, merchandise, show materials, equipment, etc., of any kind are brought into your leased space. In that case, security services are required from time of arrival until the materials are removed from the facility. No armed security is allowed unless specifically approved by the Walter E. Washington Convention Center. If cash is being handled on site, use of a MPD officer will be required.*

* A list of security providers are provided on the following page. Note that only companies licensed and bonded in the District of Columbia may perform security work on the Walter E. Washington Convention Center premises.

WHAT'S INCLUDED

Meeting Room & Ballroom Rental

Initial Setup of Meeting Space includes:

- One-time standard set-up in theater, classroom, or banquet style
- Skirted head table for four (4)
- Water service for speaker's platform
- One (1) standard lectern (upon request)
- One (1) wired microphone and house sound system (upon request)
- Skirted registration table, literature table and easel outside room (upon request)
- Skirted speaker's riser in rooms set for 100 or more
- Four standard preset lighting

Heating, Ventilation and Air Conditioning, as appropriate, in all show management, registration, meeting and exhibit areas. Lessee receives controlled temperature during show hours at no charge. Charges will apply if additional controlled temperature is required during move-in/move-out or nonevent hours.

Cleaning Services during your event; thorough daily cleaning of meeting rooms, public areas, and restrooms.

24-Hour Building Security Patrols for corridors and common areas including daily securing of meeting and exhibit space.

Building-Wide Complimentary Wi-Fi extends throughout the public areas as well as exhibit halls, meeting rooms and ballrooms to allow guests to get online with ease.

Exhibit Hall Rental

Cleaning Services during your event includes thorough cleaning of public areas and restrooms, as well as (1) daily room refresh. Cleaning does not include individual booths, exhibit space, exhibit aisles before or after carpet is laid nor the vacuuming of aisle carpet. Lessee is responsible for removal of all bulk trash, crates, lumber, and packing materials prior to show opening, during and following move-out. Any costs incurred for trash not removed by the lessee will be charged to the lessee at the prevailing rate. There will be no charge for containers or materials placed in the surrounds for the purpose of recycling.

Heating, Ventilation and Air Conditioning, full lighting, heating and air-conditioning are provided during event hours. Fifty percent lighting will be maintained during move in/out periods, rehearsals, and similar pre/post event activities. The lessee will be assessed a utility charge for special lighting and comfort-level requirements during move-in and move-out.

Show Office: one permanent show office shall be provided for each exhibit hall licensed.

General Sessions Held in Exhibit Halls

Rental fee includes:

- One-time standard set-up for a maximum of 6,000 seats per hall. (inventory permitting)
- Main stage at single height — maximum dimensions

40'W x 32'D x 48"H (inventory permitting).
* Additional equipment such as dance floor units, production platforms, camera risers, additional seating, etc. will be charged at the prevailing rate.

Registration and Common Areas

East and West Salons, L Street Bridge, Grand Lobby and public areas are commonly used for registration, circulation, message centers, information, ticket sales, receptions, distribution of publications, etc. Use of this space is subject to approval by Convention Center management.

Registration plans and space utilization must be approved in advance.

- 24 hour building security patrols for corridors and common areas (not to include registration areas)
- The movement of any furniture or plants may not be moved without approval of the Walter E. Washington Convention Center. Additional fees will apply.

