

FLOOR PLANS



WALTER E. WASHINGTON CONVENTION CENTER

Lower Level (LEVEL L)

Exhibit Halls A, B & C

BUILDING LEGEND

<ul style="list-style-type: none"> ■ - COLUMNS W - WOMEN'S RESTROOM M - MEN'S RESTROOM E - ESCALATOR [] - CONCESSIONS [] - MECHANICAL AREAS ⊙ - EXIT 	<ul style="list-style-type: none"> T - TELEPHONES S - STROBES F - FIRE EXTINGUISHER CABINET A - ART WF - WATER FOUNTAIN TH - THERMOSTAT AED - AUTOMATIC EXTERNAL DEFIBRILLATORS 	<p>ELEVATOR LEGEND</p> <ul style="list-style-type: none"> S - SOUTH M - MIDDLE N - NORTH <p>ELEVATOR TYPE</p> <ul style="list-style-type: none"> F - FREIGHT ELEVATOR P - PASSENGER ELEVATOR S - SERVICE ELEVATOR <p>EXAMPLE: MP16=MIDDLE PASSENGER ELEVATOR #16</p>	<p>LINETYPE LEGEND</p> <ul style="list-style-type: none"> --- ROLL-UP DOORS --- AIRWALLS --- LOW CEILING
---	--	--	---

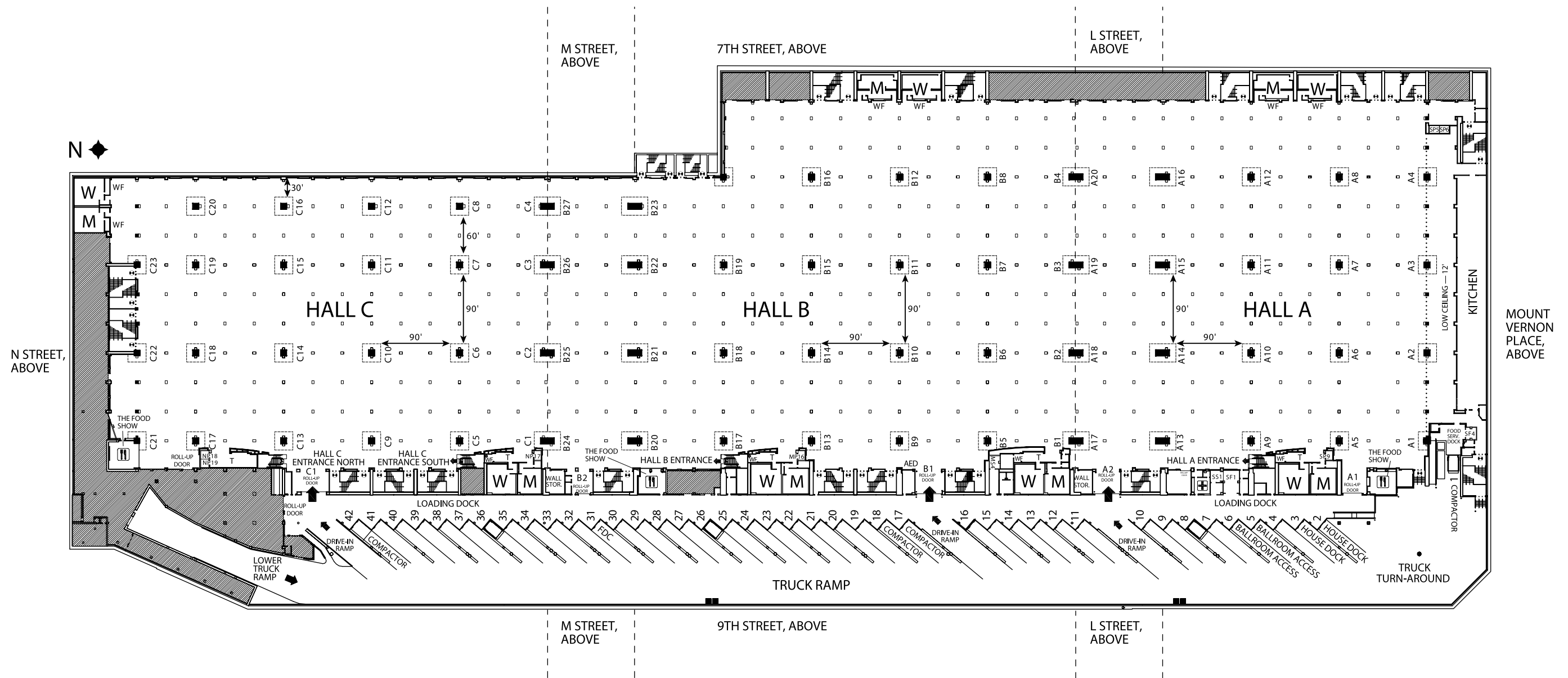

Lower Level

(LEVEL L)

Halls A, B & C

HALL A
151,000 square feet

HALL B
194,000 square feet

HALL C
128,000 square feet

TOTAL CONTIGUOUS SQUARE FEET
473,000

2,500 booths (10 feet x 10 feet)

COLUMNS
Predominantly 90-foot centers; 60-foot centers on the northeast sides of Halls B and C

CEILING HEIGHT
Predominantly 30 feet; 10,000 square foot area at 12 feet on south side of Hall A

FREIGHT DOCKS
39 enclosed docks

FREIGHT ACCESS
3 drive-in doors (25 feet wide x 15 feet high)
2 overhead doors (19 feet wide x 15 feet high)

FLOOR LOAD CAPACITY
350 lbs. per square foot

LIGHTING
Hi Bay fluorescent and dimmable incandescent.

UTILITIES AND SERVICES
Floor Boxes on 30 foot centers contain:

Electrical
120/208 volt, single phase and 3 phase

Telephone/Data
Voice and data outlets; single mode and multimode fiber connections

Audio and Video at Multiple Boxes
XLR mic and line connectors

Plumbing
3-inch drain

On Columns:

Electrical
120/208 volt, single phase and 3 phase

Audio and Video at Multiple Columns
Paging, video, multipin audio connectors

Plumbing
1-inch water line; 1-inch compressed air pipe; can be routed to floor boxes via conduit in floor

Overhead
20/208 volt, single phase and 3 phase

FOOD SERVICE
Three permanent concession stands

RESTROOMS
7 sets of men's and women's rooms, (2 in Halls A and C, 3 in Hall B)

SHOW OFFICES
Overlooking halls, see Concourse Level

FIRST AID
Permanent room; access from inside Hall A and loading dock

KITCHEN
8,000-square-foot service kitchen on south side of Hall A

Lower Level

(LEVEL L)

Capacities and Dimensions

ROOM #	USABLE DIMENSIONS FT, LENGTH X WIDTH	USABLE DIMENSIONS M, LENGTH X WIDTH	USABLE SQ FT	USABLE SQ METERS	CEILING HEIGHT FT	CEILING HEIGHT M
Hall ABC	353'7" x 1347' w	107.7m x 410.5m	473,000	43,943.1	30'	9.1
Hall AB	353'7" x 929'9" w	107.7m x 283.4m	345,000	32,051.5	30'	9.1
Hall BC	353'7" x 957'7" w	107.7m x 291.8m	322,000	29,914.8	30'	9.1
Hall A	353'7" x 390'4" w	107.7m x 118.9m	151,000	14,028.4	30'	9.1
Hall B	353'7" x 540' w	107.7m x 164.6m	194,000	18,023.2	30'	9.1
Hall C	275'10" x 416'10" w	84.1m x 127.1m	128,000	11,891.6	30'	9.1

Subtotals based on maximum room configuration capacity

Water, Natural Gas & Compressed Air Service

Hall A				Hall B				Hall C			
COLUMN #	WATER	COMP. AIR	NAT. GAS	COLUMN #	WATER	COMP. AIR	NAT. GAS	COLUMN #	WATER	COMP. AIR	NAT. GAS
A-1	X	X		B-1		X		C-1		X	
A-2		X		B-2		X		C-2		X	
A-3	X	X		B-3		X		C-3	X	X	
A-4		X		B-4		X		C-4		X	
A-4+	X	X		B-4+		X		C-4+		X	
A-5		X	X	B-5	X	X		C-5		X	
A-6	X	X	X	B-6		X		C-6	X	X	
A-7		X		B-7	X	X		C-7		X	
A-8	X	X		B-8		X		C-8			
A-8+		X		B-8+		X		C-8+	X	X	
A-9	X	X	X	B-9		X		C-9	X	X	X
A-10		X		B-10	X	X		C-10		X	
A-11	X	X		B-11		X		C-11	X	X	X
A-12		X		B-12	X	X		C-12			
A-12+		X	X	B-12+		X		C-12+		X	X
A-13		X		B-13		X	X	C-13		X	
A-14	X	X		B-14	X	X		C-14	X	X	
A-15		X		B-15		X		C-15		X	
A-16	X	X		B-16	X	X	X	C-16			
A-16+		X	X	B-16+		X	X	C-16+	X	X	
				B-17	X	X		C-17	X	X	
				B-18		X		C-18		X	
				B-19	X	X		C-19	X	X	
				B-19 +		X		C-20		X	
				B-20		X		C-20+		A	
				B-21		X		C-21			
				B-22	X	X		C-22			
				B-23		X		C-23			
				B-23 +	X	X		C-24			
								C-24+			

Column number with "+" indicates eastern wall in line with previous column

Concourse

(LEVEL C)

Exhibit Halls A, B & C

BUILDING LEGEND

■ - COLUMNS	T - TELEPHONES	ELEVATOR LEGEND	
W - WOMEN'S RESTROOM	S - STROBES	BUILDING TYPE	
M - MEN'S RESTROOM	F - FIRE EXTINGUISHER CABINET	S - SOUTH	M - MIDDLE
E - ESCALATOR	A - ART	N - NORTH	N - NORTH
☐ - CONCESSIONS	WF - WATER FOUNTAIN	ELEVATOR TYPE	
▨ - MECHANICAL AREAS	TH - THERMOSTAT	F - FREIGHT ELEVATOR	P - PASSENGER ELEVATOR
⊙ - EXIT		S - SERVICE ELEVATOR	
⊙ - WIFI		EXAMPLE: MP16=MIDDLE PASSENGER ELEVATOR #16	
		LINETYPE LEGEND	
		----- ROLL-UP DOORS	
		----- AIRWALLS	
	 LOW CEILING	

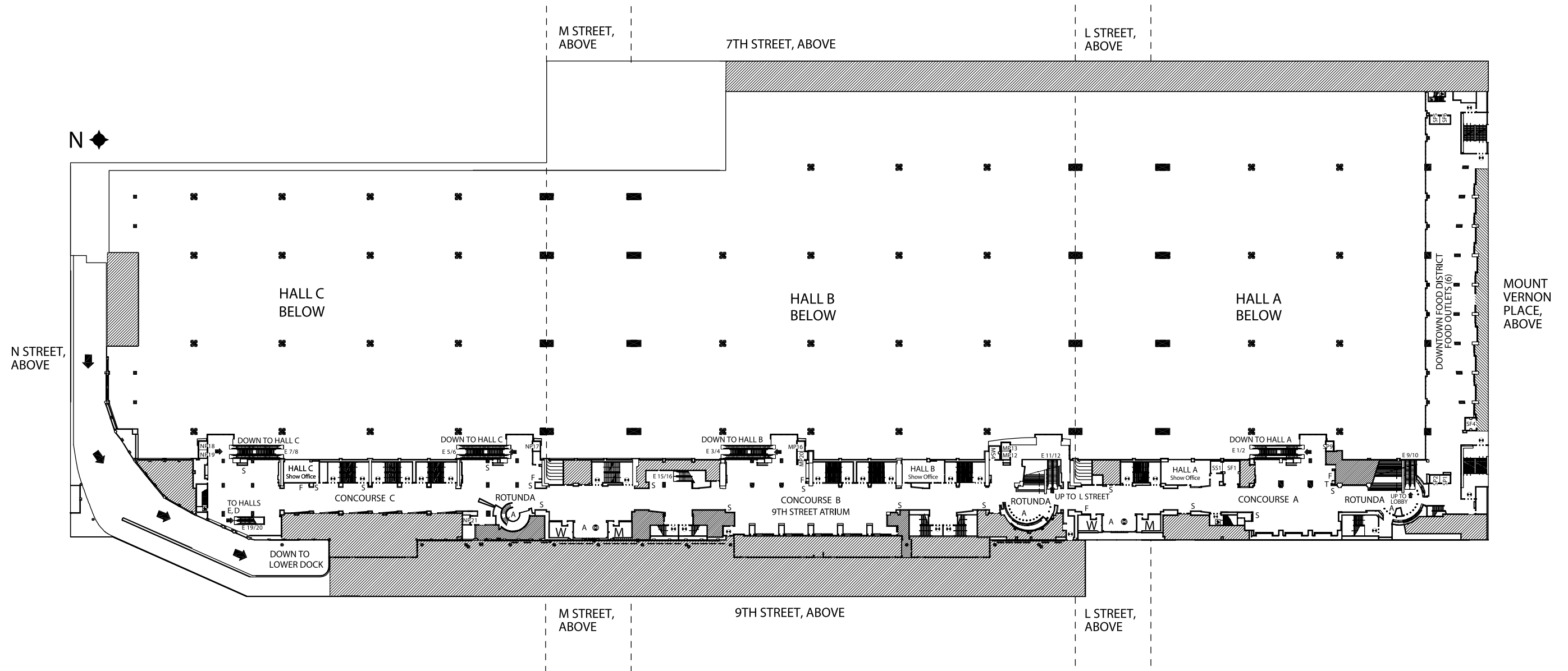
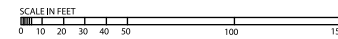

Concourse

(LEVEL C)

Exhibit Halls A, B & C

Show Offices

(overlooking halls)

HALL A

1,050 square feet

HALL B

800 square feet

HALL C

800 square feet

All the show offices on this level have restrooms.

Street Level

(LEVEL 1)

Capacities and Dimensions

ROOM #	USABLE DIMENSIONS		USABLE SQ. FT	USABLE SQ. METERS	CEILING HEIGHT		THEATER*	BANQUET**	CLASSROOM***
	FT, LENGTH X WIDTH	M, LENGTH X WIDTH			FT	M			
101	52'6" x 38'2"	16m x 11.6m	2000	185.8	12'6"	3.8	206	120	72
102AB	72'3" x 45'9"	22m x 13.9m	3700	343.7	12'6"	3.8	357	190	132
102A	45'9" x 29'6"	13.9m x 8.9m	1400	130.0	12'6"	3.8	130	70	42
102B	53'9" x 36'9"	16.4m x 11.2m	2300	213.7	12'6"	3.8	228	120	70
103AB	78'7" x 47'8"	23.9 x 14.6	4240	393.9	12'5"	3.8	424	212	170
103A	47' x 48'	14.3 x 14.6	2500	232.3	12'5"	3.8	242	130	99
103B	42'3" x 36'9"	12.8 x 11.2	1740	161.7	12'5"	3.8	174	87	70
140AB	62'8" x 51'8"	19.1m x 15.7m	3500	325.1	18'	5.5	384	200	150
140A	51'8" x 30'6"	15.7m x 9.3m	1800	167.2	18'	5.5	180	80	54
140B	51'8" x 30'6"	15.7m x 9.3m	1800	167.2	18'	5.5	180	80	54
141	28'3" x 29'	8.6m x 8.8m	800	74.3	18'	5.5	70	40	24
142	29'7" x 27'8"	9m x 8.4m	840	78.0	18'	5.5	77	40	24
143ABC	85' x 56'6"	25.9m x 17.2m	4800	445.9	17'7"	5.4	545	240	200
143AB	57'6" x 56'6"	17.5m x 17.2m	3250	301.9	17'7"	5.4	364	160	128
143BC	57'6" x 56'6"	17.5m x 17.2m	3250	301.9	17'7"	5.4	364	160	128
143A	56'6" x 27'6"	17.2m x 8.4m	1600	148.6	17'7"	5.4	117	80	54
143B	56'6" x 30'	17.2m x 9.1m	1650	153.3	17'7"	5.4	117	80	54
143C	56'6" x 27'6"	17.2m x 8.4m	1600	148.6	17'7"	5.4	117	80	54
144ABC	87'1" x 56'6"	26.5m x 17.2m	4800	445.9	17'7"	5.4	546	240	200
144AB	59'3" x 56'6"	18.1m x 17.2m	3250	301.9	17'7"	5.4	364	160	128
144BC	57'6" x 56'6"	17.5m x 17.2m	3250	301.9	17'7"	5.4	364	160	128
144A	56'6" x 27'6"	17.2m x 8.4m	1600	148.6	17'7"	5.4	117	80	54
144B	56'6" x 30'	17.2m x 9.1m	1650	153.3	17'7"	5.4	117	80	54
144C	56'6" x 27'6"	17.2m x 8.4m	1600	148.6	17'7"	5.4	117	80	54
145AB	74'2" x 73'	22.6m x 22.3m	5600	520.3	17'3"	5.3	684	300	264
145A	74'2" x 36'6"	22.6m x 11.1m	2800	260.1	17'3"	5.3	285	120	108
145B	74'2" x 36'6"	22.6m x 11.1m	2800	260.1	17'3"	5.3	285	120	108
146ABC	153'10" x 82'2"	46.9m x 25m	12500	1,161.3	17'-22'	5.2-6.7	1458	670	529
146AB	102'11" x 82'2"	31.4m x 25m	8300	771.1	17'-22'	5.2-6.7	918	430	319
146BC	102'11" x 82'2"	31.4m x 25m	8300	771.1	17'-22'	5.2-6.7	918	430	319
146A	82'2" x 50'11"	25m x 15.5m	4200	390.2	17'-22'	5.2-6.7	432	240	189
146B	82'2" x 52'	25m x 15.8m	4100	380.9	17'-22'	5.2-6.7	522	210	193
146C	82'2" x 50'11"	25m x 15.5m	4200	390.2	17'-22'	5.2-6.7	432	240	189
147AB	74'2" x 74'7"	22.6m x 22.7m	5600	520.3	17'3"	5.3	560	300	264
147A	74'2" x 36'6"	22.6m x 11.1m	2800	260.1	17'3"	5.3	285	120	108
147B	74'2" x 36'6"	22.6m x 11.1m	2800	260.1	17'3"	5.3	285	120	108
148	28' x 25'1"	8.5m x 7.6m	700	65.0	14'	4.3	56	30	16
149AB	64' x 27'	19.5m x 8.2m	1800	167.2	17'6"	5.3	192	100	60
149A	37'7" x 27'	11.5m x 8.2m	1000	92.9	17'6"	5.3	96	40	30
149B	27' x 28'11"	8.2m x 8.8m	800	74.3	17'6"	5.3	84	40	24
150AB	70'10" x 73'1"	21.6m x 22.3m	5300	492.4	17'3"	5.3	594	300	242
150A	70'10" x 37'	21.6m x 11.3m	2700	250.8	17'3"	5.3	270	150	108
150B	70'10" x 37'	21.6m x 11.3m	2700	250.8	17'3"	5.3	270	150	108
151AB	63'4" x 89'2"	19.3m x 27.2m	6000	557.4	17'3"	5.3	609	300	234
151A	63'4" x 42'	19.3m x 12.8m	3100	287.9	17'3"	5.3	288	150	110
151B	63'4" x 42'	19.3m x 12.8m	3100	287.9	17'3"	5.3	288	150	110
152AB	70'10" x 74'	21.6m x 22.5m	5300	492.4	17'3"	5.3	594	300	242
152A	70'10" x 37'	21.6m x 11.3m	2700	250.8	17'3"	5.3	270	150	108
152B	70'10" x 37'	21.6m x 11.3m	2700	250.8	17'3"	5.3	270	150	108
153	28' x 25'1"	8.5m x 7.6m	700	65.0	14'	4.3	48	30	24
154AB	76'8" x 27'	23.4m x 8.2m	2100	195.1	17'6"	5.3	228	100	72
154A	37'7" x 27'	11.5m x 8.2m	1000	92.9	17'6"	5.3	108	40	30
154B	39'11" x 27'	12.2m x 8.2m	1100	102.2	17'6"	5.3	108	50	30
155	37'2" x 22'4"	11.3m x 6.8m	800	74.3	14'	4.3	74	40	24
156	48'7" x 28'9"	14.8m x 8.8m	1500	139.4	17'6"	5.3	144	80	70
157	28'2" x 18'3"	8.2m x 5.6m	530	49.2	14'	4.3	40	20	18
158AB	59'3" x 27'	18.1m x 8.2m	1500	139.4	14'	4.3	140	80	54
158A	22'6" x 24'	6.9m x 7.3m	750	69.7	14'	4.3	65	40	24
158B	22'6" x 24'	6.9m x 7.3m	750	69.7	14'	4.3	65	40	24
159AB	59'3" x 24'	18.1m x 7.3m	1500	139.4	14'	4.3	140	80	54
159A	22'6" x 24'	6.9m x 7.3m	750	69.7	14'	4.3	65	40	24
159B	22'6" x 24'	6.9m x 7.3m	750	69.7	14'	4.3	65	40	24
160	24' x 19'7"	7.3m x 5.9m	600	55.7	14'	4.3	45	20	18

* Theater capacities based on chairs set 36" from front edge to front edge. ** Banquet capacities based on 10 chairs per 6' round table set on 11' centers.

*** Classroom capacities based on 3 chairs per 8' x 18" table and 2 chairs per 6' x 18" table.

Street Level

(LEVEL 1)

Grand Lobby/Registration/Salons A-I
Meeting Rooms 101-103 & 140-160
Loading Dock Entrance

BUILDING LEGEND

■ - COLUMNS	T - TELEPHONES	ELEVATOR LEGEND	LINETYPE LEGEND
W - WOMEN'S RESTROOM	S - STROBES	BUILDING TYPE	--- ROLL-UP DOORS
M - MEN'S RESTROOM	F - FIRE EXTINGUISHER CABINET	S - SOUTH	--- AIRWALLS
E - ESCALATOR	A - ART	M - MIDDLE	--- LOW CEILING
☐ - CONCESSIONS	WF - WATER FOUNTAIN	N - NORTH	--- SKYFOLD AIRWALLS
▨ - MECHANICAL AREAS	TH - THERMOSTAT	ELEVATOR TYPE	
⬇ - EXIT	ATM - AUTOMATIC TELLER MACHINE	F - FREIGHT ELEVATOR	
📶 - WiFi	AED - AUTOMATIC EXTERNAL DEFIBRILLATORS	P - PASSENGER ELEVATOR	
		S - SERVICE ELEVATOR	
		EXAMPLE: MP16=MIDDLE PASSENGER ELEVATOR #16	

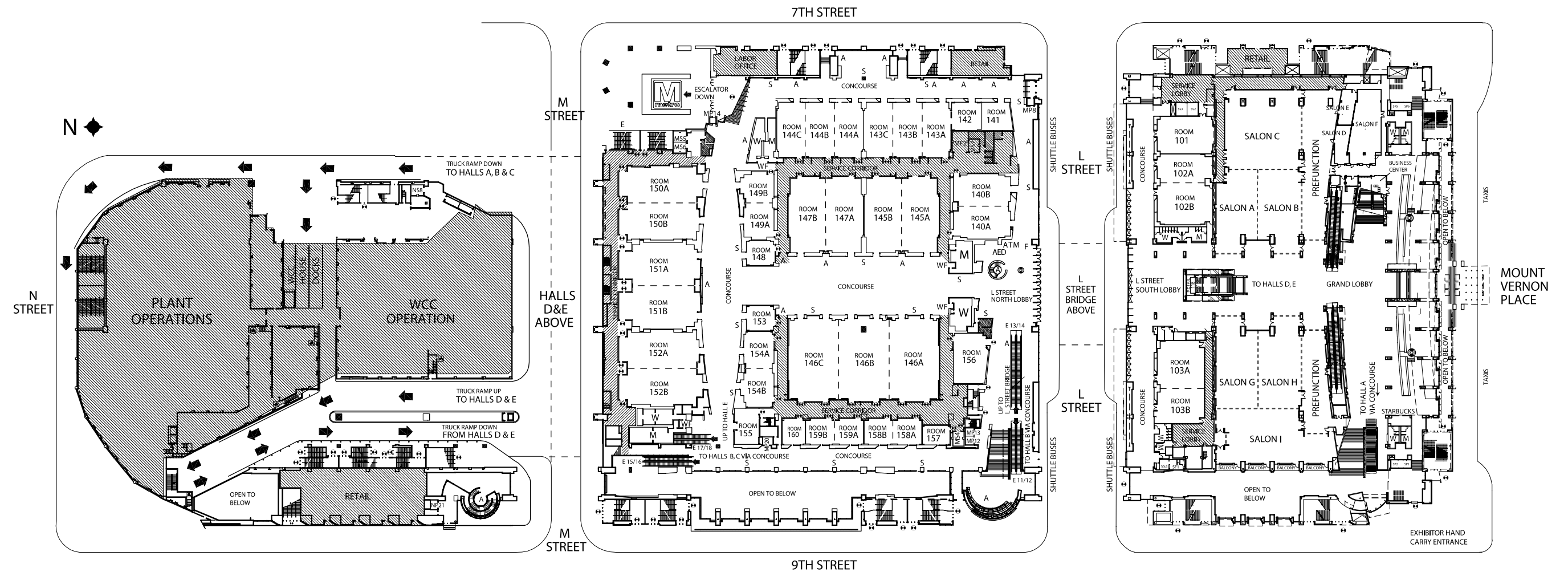
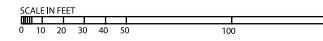

Street Level (LEVEL 1)

Grand Lobby

Glass and wood walls with a dramatic staircase

SQUARE FEET

15,000

CEILING HEIGHT

More than 80 feet

LIGHTING

Dimmable incandescent with uplighting on skylights

FLOOR

Granite

COMPLIMENTARY WIFI

FOOD SERVICE

Café and lounge; access to restaurant below

RESTROOMS

2 sets of men's and women's rooms

East & West Salons

SQUARE FEET

40,000

CEILING HEIGHT

18 feet

EAST FREIGHT ACCESS

Service elevators located on east side for access to Halls D and E loading docks above

WEST FREIGHT ACCESS

1 service elevator located on the west side for access to Halls A, B and C loading docks below

FLOOR LOAD CAPACITY

100 lbs. per square foot

FLOOR

Carpeted

LIGHTING

Fluorescent and dimmable incandescent

UTILITIES AND SERVICES

Electrical

Wall: 100 amp/208 110 volt 3 phase;
400 amp/208 110 volt 3 phase

Floor: 30A 3 phase

Telephone/Data

Voice and data outlets; single mode and multi-mode fiber connections

Meeting Rooms 101–103 & 140–160

UTILITIES AND SERVICES

Electrical

Wall: 100 amp/208 110 volt
3 phase; 400 amp/208 110 volt 3 phase

Floor: 30A 3 phase

Telephone/Data

Voice and data connections; single mode and multimode fiber connections

Audio and Video

XRL mic and line connectors

LIGHTING

Fluorescent and dimmable incandescent

RESTROOMS

4 sets of men's and women's rooms

Level Two (LEVEL 2)

Capacities and Dimensions: Meeting Rooms 201–210

ROOM #	USABLE DIMENSIONS	USABLE DIMENSIONS	USABLE SQ FT	USABLE SQ METERS	CEILING HEIGHT		THEATER*	BANQUET**	CLASSROOM***
	FT, LENGTH X WIDTH	M, LENGTH X WIDTH			FT	M			
201	86'11" x 45'	26.5m x 13.7m	4000	371.6	17'4"	5.3	440	180	168
202AB	78'9" x 99'4"	24m x 30.3m	8100	752.5	16'9"	5.1	912	400	384
202A	78'9" x 52'3"	24m x 15.9m	4200	390.2	16'9"	5.1	538	240	195
202B	78'9" x 48'	24m x 14.6m	4000	371.6	16'9"	5.1	484	180	169
203AB	57'11" x 26'3"	17.6m x 8m	1500	139.4	13'6"	4.1	120	80	60
203A	28'9" x 23'	8.8m x 7m	800	74.0	13'6"	4.1	60	40	24
203B	28'9" x 23'	8.8m x 7m	750	69.7	13'6"	4.1	54	40	24
204ABC	97'7" x 41'11"	29.7m x 12.8m	4200	390.2	16'9"	5.1	450	210	165
204AB	59'5" x 41'11"	18.1m x 12.8m	2600	241.5	16'9"	5.1	252	120	88
204BC	68' x 41'11"	20.7m x 12.8m	2900	269.4	16'9"	5.1	306	150	110
204A	42'1" x 29'2"	12.8m x 8.8m	1300	120.8	16'9"	5.1	99	60	42
204B	42'1" x 30'	12.8m x 9.1m	1300	120.8	16'9"	5.1	121	60	42
204C	42'2" x 38'2"	12.8m x 11.6m	1600	148.6	16'9"	5.1	160	90	56
205	26'6" x 20'4"	8.1m x 6.2m	600	55.7	16'	4.9	42	30	20
206	85' x 45'	25.9m x 13.7m	4000	371.6	17'4"	5.3	440	180	168
207AB	78'9" x 99'4"	24m x 30.3m	8100	752.5	16'9"	5.1	912	400	384
207A	78'9" x 52'3"	24m x 15.9m	4200	390.2	16'9"	5.1	538	240	195
207B	78'9" x 48'	24m x 14.6m	4000	371.6	16'9"	5.1	484	180	169
208AB	57'11" x 23'	17.6m x 7m	1500	139.4	13'6"	4.1	120	80	60
208A	28'9" x 23'	8.8m x 7m	800	74.3	13'6"	4.1	60	40	24
208B	28'9" x 23'	8.8m x 7m	750	69.7	13'6"	4.1	54	40	24
209ABC	88'2" x 42'1"	26.9m x 12.8m	3800	353.0	16'9"	5.1	406	180	154
209AB	59'2" x 42'1"	18m x 12.8m	2600	241.5	16'9"	5.1	252	120	88
209BC	58'11" x 42'1"	17.9m x 12.8m	2500	232.3	16'9"	5.1	250	120	88
209A	42'1" x 29'2"	12.8m x 8.8m	1300	120.8	16'9"	5.1	110	60	42
209B	42'1" x 30'	12.8m x 9.1m	1300	120.8	16'9"	5.1	110	60	42
209C	42'2" x 28'9"	12.8m x 8.8m	1200	111.5	16'9"	5.1	110	60	42
210	24' x 21'10"	7.3m x 6.7m	550	51.9	16'	4.9	40	30	16
East Overlook	48' x 31'	14.63 x 9.45	1254	116.5	18	5.5	331	166	133
West Overlook	38'3" x 31'	11.66 x 9.45	1063	98.7	18	5.5	229	115	92

* Theater capacities based on chairs set 36" front edge to front edge.

** Banquet capacities based on 10 chairs per 6' round table set on 11' centers.

*** Classroom capacities based on 3 chairs per 8' x 18" table and 2 chairs per 6' x 18" table.

Capacities and Dimensions: Halls D and E

ROOM #	USABLE DIMENSIONS	USABLE DIMENSIONS	USABLE SQ FT	USABLE SQ METERS	CEILING HEIGHT	
	FT, LENGTH X WIDTH	M, LENGTH X WIDTH			FT	M
Hall DE	225'11" x 781'8"	68.8m x 238.2m	230,000	21,367.7	40'–52'9"	12.2–16.1
Hall D	225'11" x 449'3"	68.8m x 136.9m	111,000	10,312.2	40'–52'9"	12.2–16.1
Hall E	225'11" x 332'11"	68.8m x 101.4m	119,000	11,055.4	40'–52'9"	12.2–16.1

Subtotals based on maximum room configuration capacity

Level Two

(LEVEL 2)

Exhibit Halls D & E
Meeting Rooms 201-210
East and West Overlook

BUILDING LEGEND

<ul style="list-style-type: none"> ■ - COLUMNS W - WOMEN'S RESTROOM M - MEN'S RESTROOM E - ESCALATOR ☐ - CONCESSIONS ▨ - MECHANICAL AREAS ⊙ - EXIT ⊙ - WIFI 	<ul style="list-style-type: none"> T - TELEPHONES S - STROBES F - FIRE EXTINGUISHER CABINET A - ART WF - WATER FOUNTAIN TH - THERMOSTAT AED - AUTOMATIC EXTERNAL DEFIBRILLATORS 	<p>ELEVATOR LEGEND</p> <p>BUILDING TYPE</p> <ul style="list-style-type: none"> S - SOUTH M - MIDDLE N - NORTH <p>ELEVATOR TYPE</p> <ul style="list-style-type: none"> F - FREIGHT ELEVATOR P - PASSENGER ELEVATOR S - SERVICE ELEVATOR <p>EXAMPLE: MP16=MIDDLE PASSENGER ELEVATOR #16</p>	<p>LINETYPE LEGEND</p> <ul style="list-style-type: none"> --- ROLL-UP DOORS --- AIRWALLS --- LOW CEILING
---	--	--	--

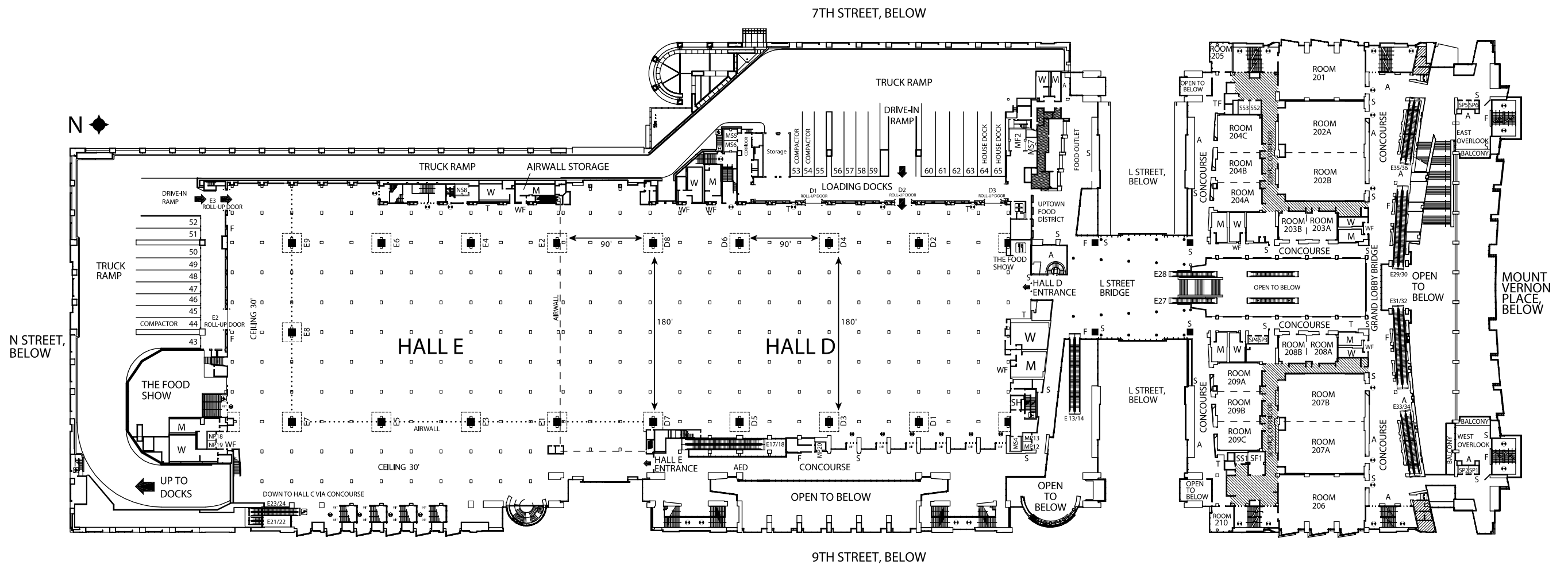
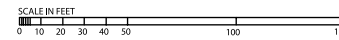

Level Two (LEVEL 2)

Halls D & E

HALL D

111,000 square feet

HALL E

119,000 square feet

TOTAL CONTIGUOUS SQUARE FEET

230,000

1,000 booths (10 feet x 10 feet)

COLUMNS

180-foot clear span between "east to west" columns

90-foot centers between "north to south" columns

CEILING HEIGHT

Ranges from 30 to 50 feet

FREIGHT DOCKS

Hall D: 10 covered docks

Hall E: 10 covered docks

FREIGHT ACCESS

Hall D:

1 drive-in (16 feet wide x 15 feet high),

2 overhead (16 feet wide x 15 feet high)

Hall E:

1 drive-in (20 feet wide x 15 feet high),

1 overhead (20 feet wide x 15 feet high)

FLOOR LOAD CAPACITY

350 lbs. per square foot

LIGHTING

Hi Bay fluorescent and dimmable incandescent

UTILITIES AND SERVICES

Floor boxes on 30 foot centers contain:

Electrical

120/208 volt, single phase and 3 phase

Telephone/Data

Single mode and multimode fiber connections

Audio and Video at Multiple Boxes

XLR mic and line connectors

RJ45 audio inputs

Plumbing

3-inch drain

On Columns:

Electrical

120/208 volt, single phase and 3 phase

Audio and Video at Multiple Columns

Paging, video and multipin audio connectors

Plumbing

1-inch water line; 1-inch compressed air pipe; can be routed to floor boxes via conduit in floor

Overhead

120/208 volt, single phase and 3 phase

FOOD SERVICE

Permanent concession stand inside Hall D, food court outside Hall D, café overlooking Hall E

RESTROOMS

4 sets of men's and women's rooms, (2 sets in Hall D, 2 sets in Hall E)

SHOW OFFICES

Hall D: 140 square feet (south wall of Hall D)

Hall E: 1,400 square feet (overlooks north side of Hall E)

FIRST AID

Permanent room; access from inside Hall D and loading dock

Meeting Rooms 201–210 East and West Overlook

Electrical

100 amp/208 volt 3 phase; 400 amp/208 volt 3 phase

Telephone/Data

Voice and data connections; single mode and multimode fiber connections

Audio and Video

XLR mic and line connectors

Audio inputs

Lighting

Fluorescent with bi-level switching and dimmable incandescent

RESTROOMS

4 sets of men's and women's rooms

Level Three (LEVEL 3)

Capacities and Dimensions: Meeting Rooms 301–306

ROOM #	USABLE DIMENSIONS	USABLE DIMENSIONS	USABLE SQ FT	USABLE SQ METERS	CEILING HEIGHT		THEATER*	BANQUET**	CLASSROOM***
	FT, LENGTH X WIDTH	M, LENGTH X WIDTH			FT	M			
301	25' x 28'10"	7.6m x 8.8m	775	71.9	10'	3	40	40	30
302	25' x 28'10"	7.6m x 8.8m	775	71.9	10'	3	40	40	30
303	25' x 28'10"	7.6m x 8.8m	775	71.9	10'	3	40	40	30
304	25' x 28'10"	7.6m x 8.8m	775	71.9	10'	3	40	40	30
305	25' x 28'10"	7.6m x 8.8m	775	71.9	10'	3	40	40	30
306	25' x 28'10"	7.6m x 8.8m	775	71.9	10'	3	40	40	30

* Theater capacities based on chairs set 36" front edge to front edge.

** Banquet capacities based on 10 chairs per 6' round table set on 11' centers.

*** Classroom capacities based on 3 chairs per 8' x 18" table and 2 chairs per 6' x 18" table.

Capacities and Dimensions: Ballroom ABC

ROOM #	USABLE DIMENSIONS	USABLE DIMENSIONS	USABLE SQ FT	USABLE SQ METERS	CEILING HEIGHT		THEATER*	BANQUET**	CLASSROOM***
	FT, LENGTH X WIDTH	M, LENGTH X WIDTH			FT	M			
Ballroom ABC	267'11" x 140'2"	81.7m x 42.1m	52000	4830.9	40'–48'	12.2–14.6	4600	2780	2460
Ballroom AB	186'9" x 140'2"	56.9m x 42.1m	33000	3065.8	40'–48'	12.2–14.6	2800	1300	1512
Ballroom BC	186'9" x 140'2"	56.9m x 42.1m	33000	3065.8	40'–48'	12.2–14.6	2800	1300	1512
Ballroom A	140'2" x 97'2"	42.1m x 29.6m	19000	1765.2	40'–48'	12.2–14.6	1633	840	800
Ballroom B	140'2" x 89'6"	42.1m x 27.2m	14000	1300.6	40'–48'	12.2–14.6	1400	780	700
Ballroom C	140'2" x 97'2"	42.1m x 29.6m	19000	1765.2	40'–48'	12.2–14.6	1633	840	800

* Theater capacities based on chairs set 36" from front edge to front edge.

** Banquet capacities based on 10 chairs per 6' round table.

*** Classroom capacities based on 4 chairs per 8' x 18" table and 3 chairs per 6' x 18" table.

Water, Natural Gas & Compressed Air Service

Hall D

COLUMN #	WATER	COMP. AIR	NAT. GAS
West entrance wall	X	X	
East entrance wall	X	X	
D-1	X	X	
D-2	X	X	
D-3	X	X	X
D-4	X	X	X
D-5	X	X	
D-6	X	X	
D-7	X	X	
D-8	X	X	

Hall E

COLUMN #	WATER	COMP. AIR	NAT. GAS
E-1	X	X	
E-2	X	X	
E-3	X	X	
E-4	X	X	
E-5	X	X	X
E-6	X	X	X
E-7	X	X	
E-8	X	X	
E-9	X	X	

Level Three

(LEVEL 3)

Ballroom
Meeting Rooms 301-306
Kitchen

BUILDING LEGEND

■ - COLUMNS	T - TELEPHONES	ELEVATOR LEGEND	LINETYPE LEGEND
W - WOMEN'S RESTROOM	S - STROBES	BUILDING TYPE	----- ROLL-UP DOORS
M - MEN'S RESTROOM	F - FIRE EXTINGUISHER CABINET	S - SOUTH	----- AIRWALLS
E - ESCALATOR	A - ART	M - MIDDLE LOW CEILING
☐ - CONCESSIONS	WF - WATER FOUNTAIN	N - NORTH	
▨ - MECHANICAL AREAS	TH - THERMOSTAT	ELEVATOR TYPE	
⊙ - EXIT	AED - AUTOMATIC EXTERNAL DEFIBRILLATORS	F - FREIGHT ELEVATOR	
		P - PASSENGER ELEVATOR	
		S - SERVICE ELEVATOR	
		EXAMPLE: MP16=MIDDLE PASSENGER ELEVATOR #16	

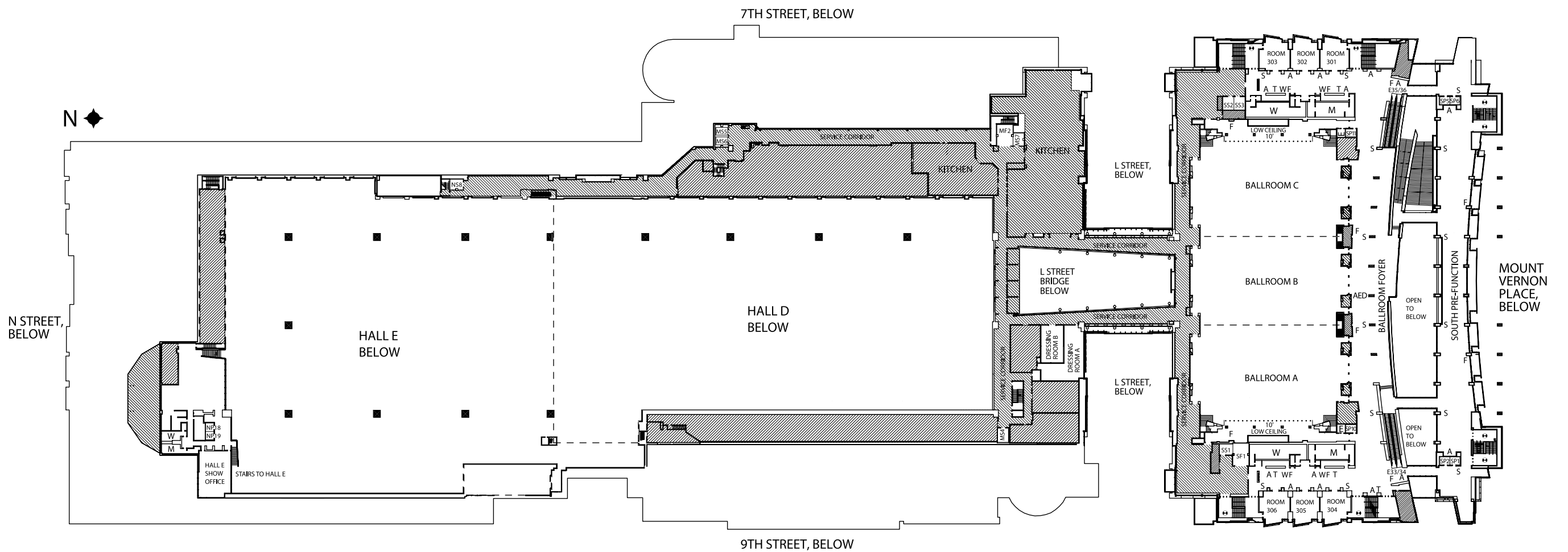
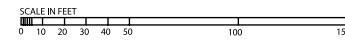

Level Three

(LEVEL 3)

Ballroom

BALLROOM A

19,000 square feet (16,400 square feet plus 2,600-square-foot balcony)

BALLROOM B

14,000 square feet

BALLROOM C

19,000 square feet (16,400 square feet plus 2,600-square-foot balcony)

TOTAL USABLE SQUARE FEET

52,000

CEILING HEIGHT

40 to 48 feet high; 10 feet under balconies

SOUTH PRE-FUNCTION

30,000 square feet with natural light

FLOOR LOAD CAPACITY

100 lbs. per square foot

FREIGHT ACCESS

2 service elevators

LIGHTING

Hi Bay fluorescent and dimmable incandescent; multiple preset options

UTILITIES AND SERVICES

Electrical

100 amp/208 volt 3 phase; 200 amp/208 volt 3 phase; 400 amp/208 volt 3 phase; 60 amp/208 volt 3 phase overhead

Telephone/Data

Voice and data connections; single mode and multimode fiber connections

Audio and Video

XLR mic and line connectors; paging, video, multipin audio connectors on walls and in floor; A/V Mezzanine across southside of ballroom

DRESSING ROOMS

A. 48' x 20'; restrooms with no showers

B. 20' x 25'; restrooms with no showers

RESTROOMS

2 sets of men's and women's rooms

KITCHEN

20,000-square-foot kitchen adjacent to the ballroom

Meeting Rooms 301–306

LIGHTING

Fluorescent with bi-level switching and dimmable incandescent

UTILITIES AND SERVICES

Electrical

100 amp/208 volt 3 phase

Telephone/Data

Voice and data connections

Audio and Video

XLR mic and line connectors

Multipin audio connectors

Salons

(LEVEL 1)

Capacities and Dimensions: Salons A-I

SALON #	USABLE DIMENSIONS		USABLE SQ FT	USABLE SQ METERS	CEILING HEIGHT		THEATER*	BANQUET**	CLASSROOM***
	FT, LENGTH X WIDTH	M, LENGTH X WIDTH			FT	M			
East Salon									
A	42' x 72'	12.8 x 21.9	3205	976.9	18	5.5	260	120	85
B	44' x 72'	13.4 x 21.9	3462	1055.2	18	5.5	300	140	100
C	78' x 80'	23.7 x 24.4	6177	1882.7	18	5.5	578	290	240
AB	72' x 88'	21.9 x 26.8	6667	2032.1	18	5.5	552	280	240
ABC	152' x 164'	46.3 x 49.9	12844	3914.9	18	5.5	1166	580	372
AB with Prefunction	72' x 116'	21.9 x 35.3	11311	3447.6	18	5.5	667	330	220
ABC with Prefunction	116' x 152'	35.3 x 46.3	17488	5330.3	18	5.5	1166	580	372
Meeting Rooms									
D	13' x 39'	3.9 x 11.9	566	172.6	10'5"	3.2	36	20	13
E	13' x 36'	3.9 x 10.9	532	162.2	10'5"	3.2	32	20	12
F	31' x 76'	9.4 x 23.2	2163	659.3	10'5"	3.2	178	80	55
West Salon									
G	42' x 82'	12.8 x 24.9	3748	1142.4	18	5.5	304	160	115
H	44' x 82'	13.4 x 24.9	3767	1148.2	18	5.5	304	160	115
I	54' x 63'	16.4 x 19.2	5770	1758.7	18	5.5	442	260	150
GH	82' x 86'	24.9 x 26.2	7515	2290.1	18	5.5	612	300	234
GI	96' x 86'	29.3 x 24.9	7515	2290.1	18	5.5	840	480	342
GHI	86' x 136'	26.2 x 41.5	13285	4049.2	18	5.5	932	480	360
GH with Prefunction	82' x 111'	24.9 x 33.8	10282	3134.1	18	5.5	1240	380	264
GHI with Prefunction	111' x 136'	33.8 x 41.5	16052	4892.7	18	5.5	1605	803	642

* Theater capacities based on chairs set 36" front edge to front edge.

** Banquet capacities based on 10 chairs per 6' round table set on 11' centers.

*** Classroom capacities based on 3 chairs per 8' x 18" table and 2 chairs per 6' x 18" table.

BUILDING LEGEND

■ - COLUMNS	T - TELEPHONES	ELEVATOR LEGEND	LINETYPE LEGEND
W - WOMEN'S RESTROOM	S - STROBES	BUILDING TYPE	ROLL-UP DOORS
M - MEN'S RESTROOM	F - FIRE EXTINGUISHER CABINET	S - SOUTH	AIRWALLS
E - ESCALATOR	A - ART	M - MIDDLE	LOW CEILING
☐ - CONCESSIONS	WF - WATER FOUNTAIN	N - NORTH	SKYFOLD AIRWALLS
▨ - MECHANICAL AREAS	TH - THERMOSTAT	ELEVATOR TYPE	
⊙ - EXIT	ATM - AUTOMATIC TELLER MACHINE	F - FREIGHT ELEVATOR	
⊙ - WIFI	AED - AUTOMATIC EXTERNAL DEFIBRILLATORS	P - PASSENGER ELEVATOR	
		S - SERVICE ELEVATOR	
		EXAMPLE: MP16=MIDDLE PASSENGER ELEVATOR #16	

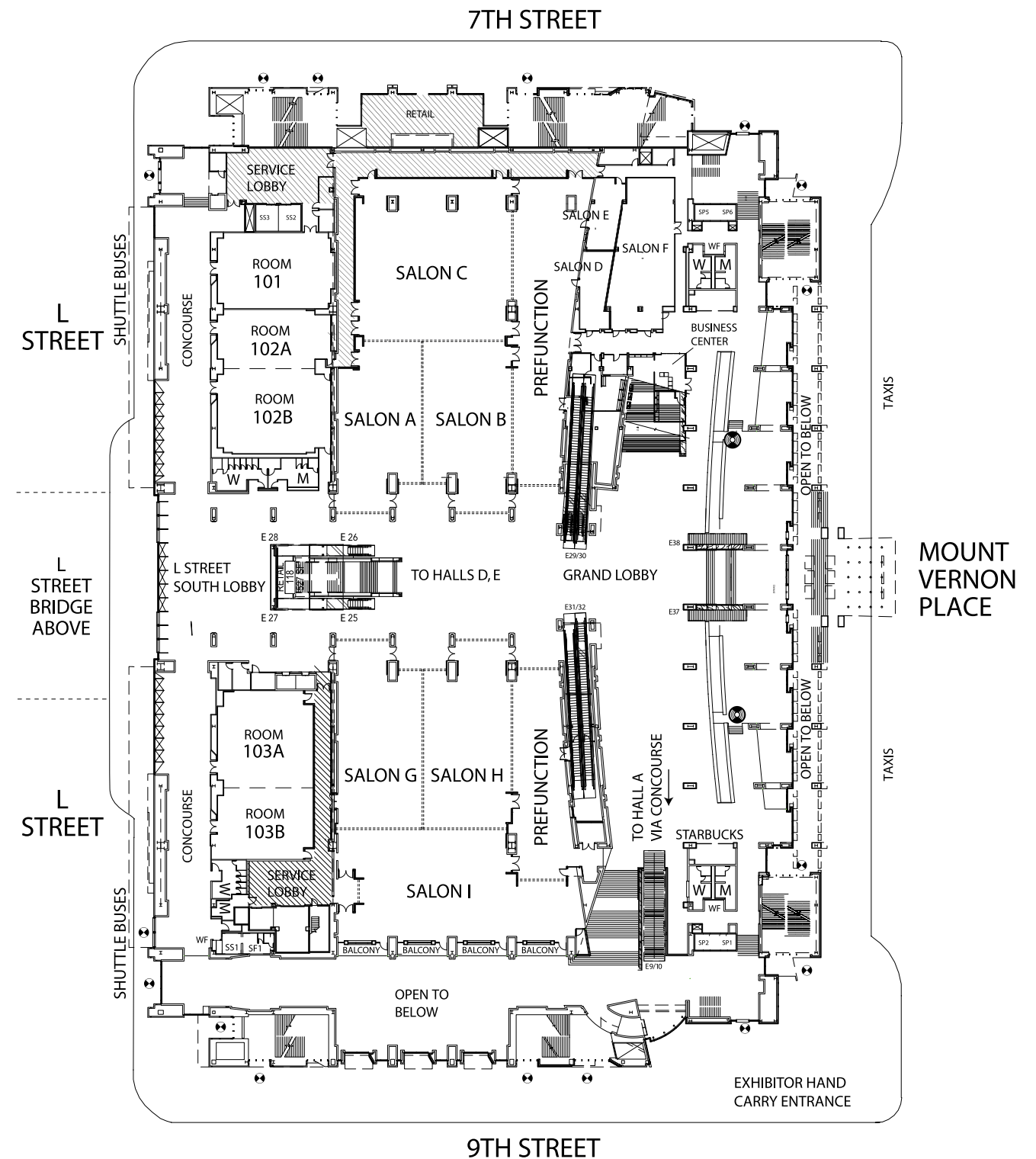

Salons

(LEVEL 1)

CEILING HEIGHT

18 feet

EAST FREIGHT ACCESS

2 service elevators located on east side for access to Halls D and E loading docks above

WEST FREIGHT ACCESS

1 service elevator located on the west side for access to Halls A, B and C loading docks below

FLOOR LOAD CAPACITY

100 lbs per square foot

UTILITIES AND SERVICES

Electrical

20 amp/120 volt on walls at 15 foot centers
100 amp/208 volt on walls at 30 foot centers

Telephone/Data

Voice and data outlets; single mode and multimode fiber connections

Lighting

Dimmable fluorescent with bi-level switching and dimmable incandescent

Audio and Video

XRL mic and line connectors
Audio inputs

Rooms 103AB

Electrical

100 amp/208 volt 3 phase; 400 amp/208 volt 3 phase

Telephone/Data

RJ45 voice and data connections; single mode and multimode fiber connections

Audio and Video

XRL mic and line connectors
Audio inputs

Lighting

Dimmable fluorescent and incandescent



WALTER E. WASHINGTON
CONVENTION CENTER

202.249.3000
800.368.9000

www.dconvention.com



800.635.6338
202.789.7000

www.destinationdc.com